

EQUIPMENT CATALOG

TRANSPORTATION

LAWN MAINTENANCE

SOIL CULTIVATION

FORESTRY

VINICULTURE

WINTER AND MUNICIPAL MAINTENANCE

FRONT LOADER



ŠÁLEK



Šálek s.r.o. produces complete, multifunctional four-wheel small tractors up to 60HP including a wide range of accessories. The company is located in the heart of Haná in Prostějov. Small tractors from Prostějov have a tradition not only in the Czech Republic but also in Europe for over half a century, since the first small tractor left the gates of Prostějov in 1955.

Small tractors Šálek s.r.o. as basic drive units in conjunction with a wide range of working tools find use primarily where there are requirements for easy maneuverability, mobility, economy in operation and especially - where the deployment of large wheeled tractors is uneconomical, such as mechanization in special areas of agricultural production, vineyards, orchards, forestry, nurseries and municipal services or in intra-company transport.

The product philosophy of Šálek s.r.o. is based on the idea of constant technological innovation and high quality.



TRANSPORTATION

ANS 1300	4
ANS 1900/ ANS1900Z	4
ANS 2800	4
ANS 3500	4
MFN 2000	6
AKN-3000	6,7
ZDV-521	8
APN-523	8
PZ-200	8

LAWN MAINTENANCE

MUL- 2000/1750/	
1500/1300/1000/800	10
MUL-1500/1300	10
BISON-1500/1250	11
BISON-1500UP/1250UP	11
SHEEP-3500/3000	12
SVM-1500/1300/1000	12
AŽR -169	13
SB-1400/1200/1000	13
BŽR -1600/1400/1200	14
DSF-1650	14
OSP-1500/1850/2250	15
PRV-1200/1000	15

SOIL CULTIVATION

AKR-140/120/100	18
AKP-122	18
AKM-172/130	18
PB4-144.4	19
PON-25A	19
PN3-300/PN2-300	19
PON2-250 H	20
PON2-300 H	20
SK2-130	20
FRA-003	21
FRA-005	21
AVB-568	21
APV-175	21
PBG-250	22
VHN-1200/1000	22
TB-120/100	22

FORESTRY

TSM-90	24
TSH -120	24
35E/30E	25
RAM-1000/1000H	25
ŠŠ-1000	25
BOBR-75/BOBR-75 TRANSPORT	26
PZ-2	26

VINICULTURE

AGP-250TN/200TN/100TN	28
AGP-1000PE	28
AGS-200/6	28
NOL-1400	29
VNS-01	30
AKR-60 T	30

WINTER AND MUNICIPAL MAINTENANCE

ARS-103	32
RAZ-001	32
ARS-171	32
ARS 250H/205H/188H/	
165H/140H/120H	33
SRS 250H/205H/188H/	
165H/140H/120H	33
SF-1500/1200	33
AZM-156	34
AZM-150hydro/120hydro	34
AZM-150M/120M	35
AZM-140 F	35
RZK-100	36
RZK-400 H/300H	36
VSN-140/120/100	37

FRONT LOADER

ND5-060	40
ND6-060-A	41
ND5-060-B	41
ND5-060-C	41
ND5-060-D	41
ND5-060-E	41
ND5-060-F	41
ND5-060-H	42
ND5-060-G	42



TRANSPORTATION

ANS 1300 | ANS 1900 | ANS 2800 | ANS 3500 | MFN 2000 | APN-523 | PZ-200 | AKN-3000 | ZDV-521

ANS 1300

TIPPING TRAILER

Single-axle tractor tipping trailers are designed for transporting various types of materials on public roads, in agriculture, forestry, horticulture, horticulture, construction and local transport. They are mainly used for transporting bulk and lump materials. The body of the trailer is tipped to the rear or to three sides by means of a hydraulic cylinder or a four-stage telescopic hoist operated directly from the driver's seat. The body of the trailer is available with folding sidewalls. The load volume can be increased by mounting a body extension. The brakes are mechanically operated with a reversing automatic brake, which ensures safe and fault-free driving even in extreme conditions. The trailer is suitable for all types of small tractors. It is approved for road use.

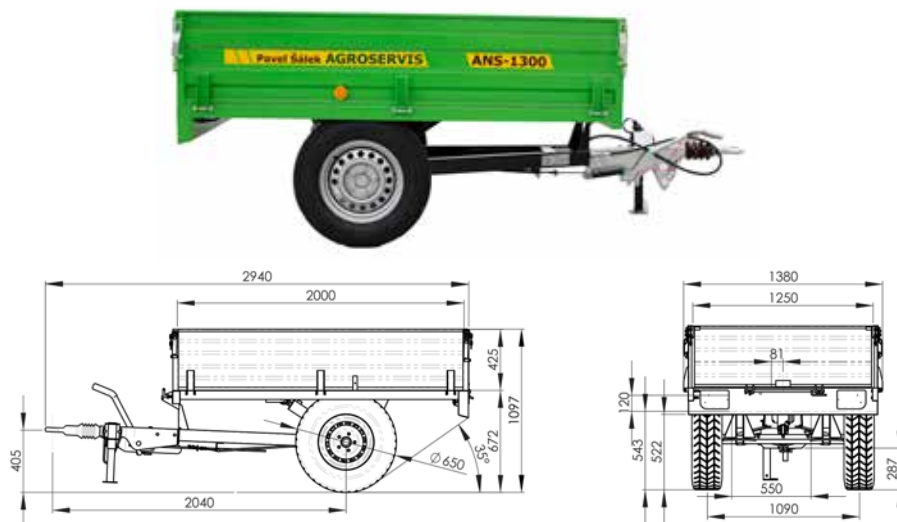

PREMIUM EQUIPMENT for all types

height-adjustable support wheel
body extension + 400 mm, net and solid versions
colours on request
drawbar height adjustment

TECHNICAL DATA

width	1 320 mm	wheelbase	1 090 mm
trailer height	285 kg	payload	1 000 kg
loading area	2.50 m ²	towing eye	35 mm
body volume	1.062 m ³	tipping angle	39°
tyre size	185 R14C	three-sided tipping	no

ANS 1900/ANS1900Z

THREE-SIDE TIPPING TRAILER

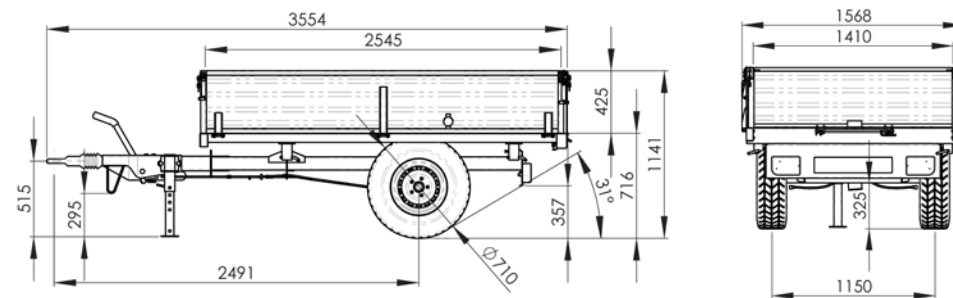

Superstructure 800 mm (standard)
net and solid

TECHNICAL DATA

width	1 500 mm	wheelbase	1 150 mm
trailer height	350 kg	payload	1 500 kg
loading area	3.70 m ²	towing eye	40 mm
body volume	1.600 m ³	tipping angle	60°
tyre size	185 R14C	three-sided tipping	yes

ANS1900Z reinforced frame with tyres 10 x 75 x 15.3

ANS 2800

THREE-SIDE TIPPING TRAILER

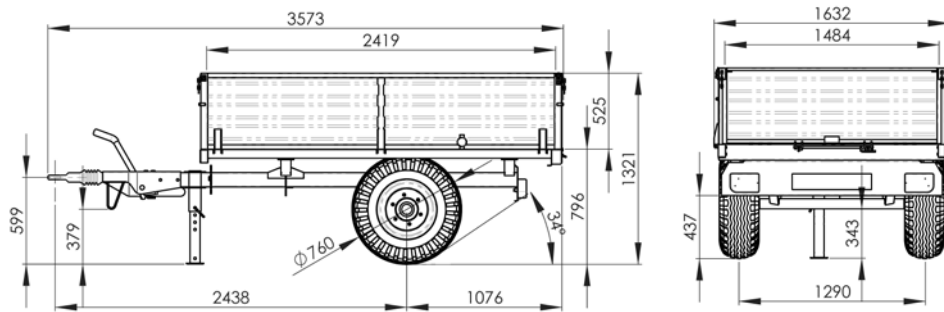

TECHNICAL DATA

width	1 560 mm	wheelbase	1 290 mm
trailer height	550 kg	payload	2 200 kg
loading area	3.75 m ²	towing eye	40 mm
body volume	1.950 m ³	tipping angle	60°
tyre size	10x75x15.3	three-sided tipping	yes

ANS 3500

THREE-SIDE TIPPING TRAILER

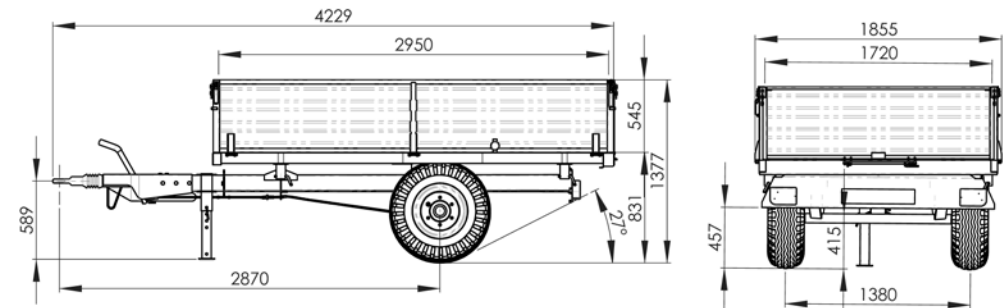

TECHNICAL DATA

width	1 850 mm	wheelbase	1 380 mm
trailer height	850 kg	payload	2 800 kg
loading area	5.40 m ²	towing eye	40 mm
body volume	2.900 m ³	tipping angle	60°
tyre size	10x75x15.3	three-sided tipping	yes

MFN 2000

SEWAGE TRAILER

The MFN-2000 is a new type of small cubic capacity sewage trailer with a payload of 2625 kg. It is designed mainly for filling, transporting and application of slurry, faeces and other agricultural wastewater. Another possible use is for irrigation of orchards, gardens, vineyards and fields with water. Sewage trailer of frameless self-supporting construction with one unsprung axle. The trailer is equipped with a pump with automatic lubrication. The pump is driven by a PTO shaft from a small tractor. Water level gauges built into both the front and rear lids are used to check the tank level. The suction of the pump is limited by a ball valve and secured by a safety valve. The pressure value is set so that it is not a pressure tank. The trailer is equipped with a ramp brake with automatic locking when reversing and a manual mechanical parking brake. The closing rear slide gate of the tank is also mechanically operated from the driver's seat.

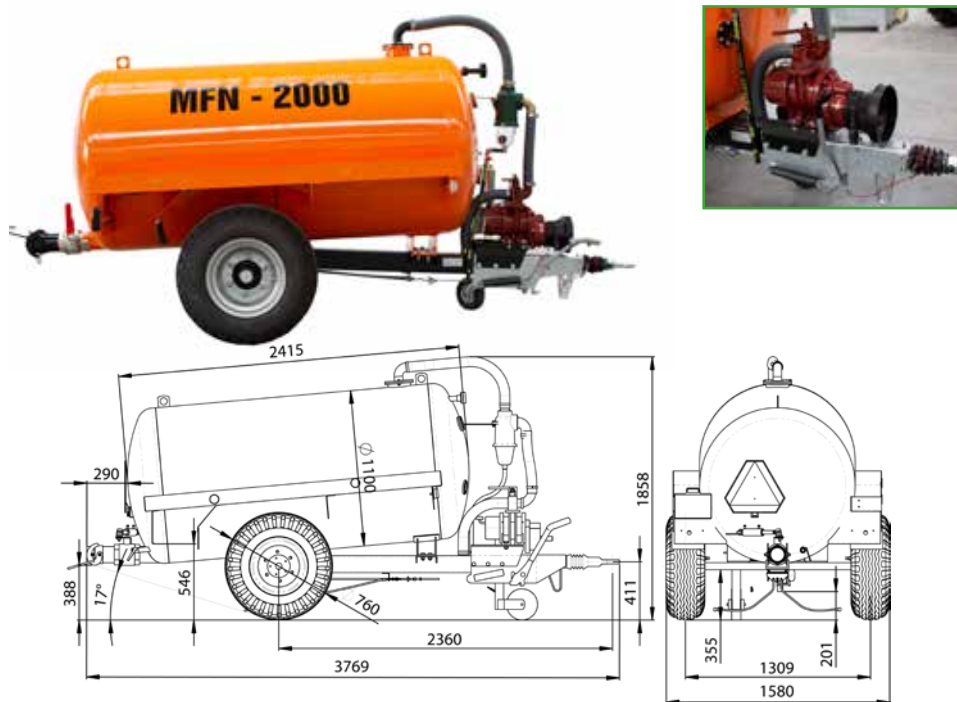

TECHNICAL DATA

tank capacity	2 100 l	towing capacity	540 rpm
max. trailer length	3 309 mm	tyres	10x75x15,3
max. trailer width	1 472 mm	autom. vacuum pump lubricated	540 rpm XE1P
max. trailer height	1 818 mm	plastic suction pipe	*100 mm
total weight	3 500 kg	service brakes	ramp drum brake
towing eye height	530 mm	parking brakes	mechanic
suction height.....	5 m (water)		

AKN-3000

CONTAINER LOADER

Šálek s.r.o. has launched a device extending the usability of small tractors in the municipal and agricultural sphere. For the collection of waste material, it offers containers in a variant for construction waste and other heavier material or large-volume for bio-waste. For the loading, removal, folding or emptying of containers, there is a SINGLE ARM ARTICULATED LOADER suspended on the small tractor and controlled by the tractor hydraulics from the driver's seat. The loader solution offers additional utility with various adapters such as spreaders, sprayers, tankers, etc.



TECHNICAL DATA

width	1 571 mm	wheelbase	1 270 mm
length	4 204 mm	tyre size	10x75x15,3
height	1 843 mm	towing eye	40 mm
total trailer weight	980 kg	tipping angle	49°
low container weight	298 kg	total load capacity	3 000 kg

AKN-3000

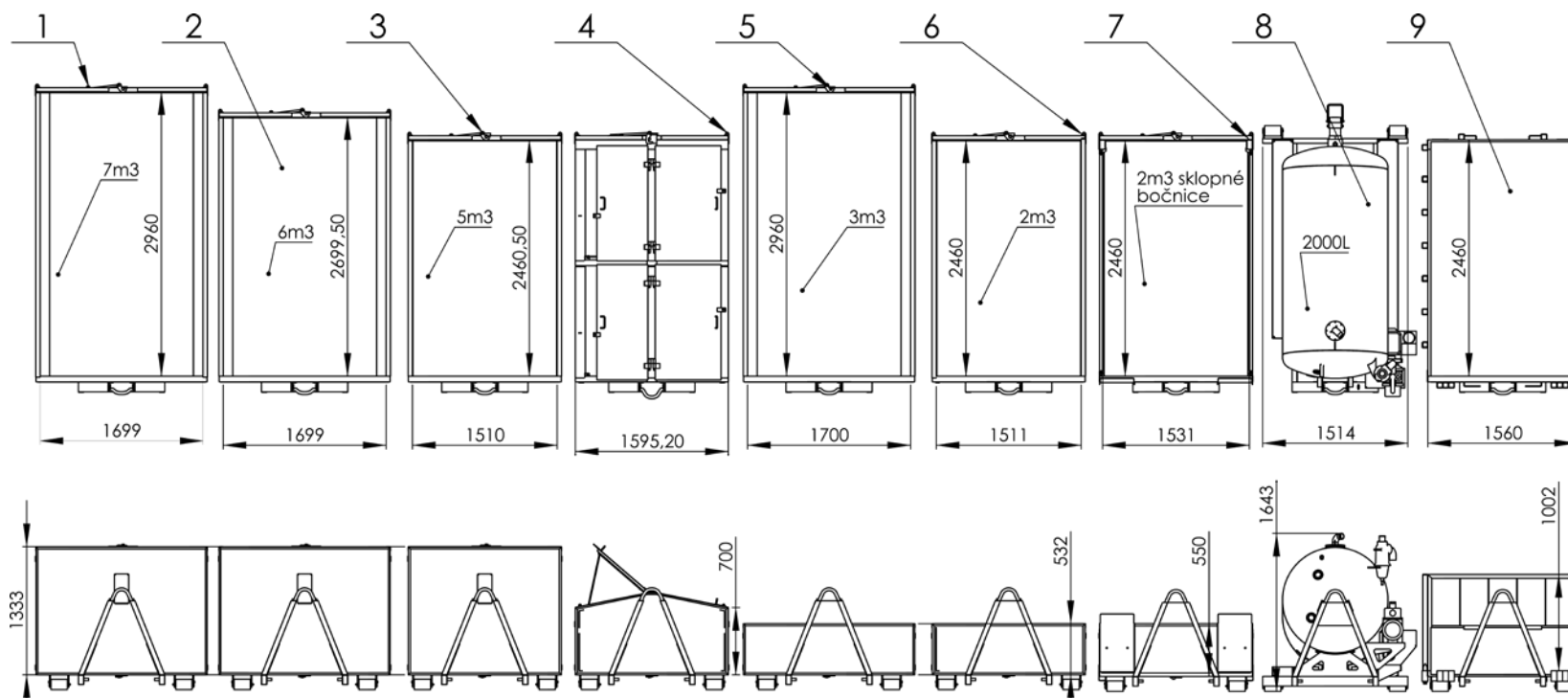
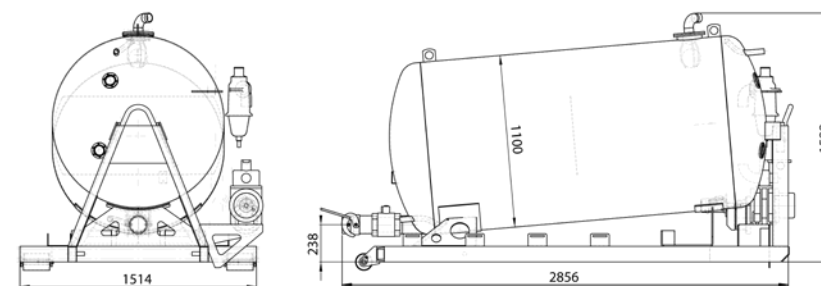
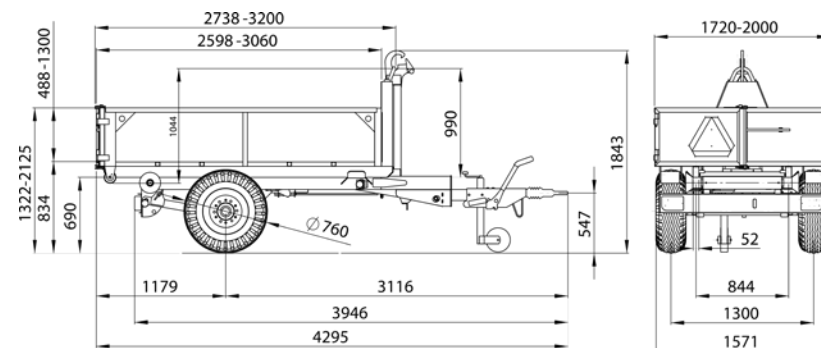
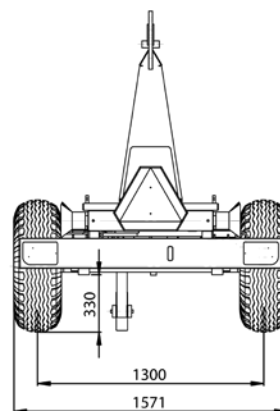
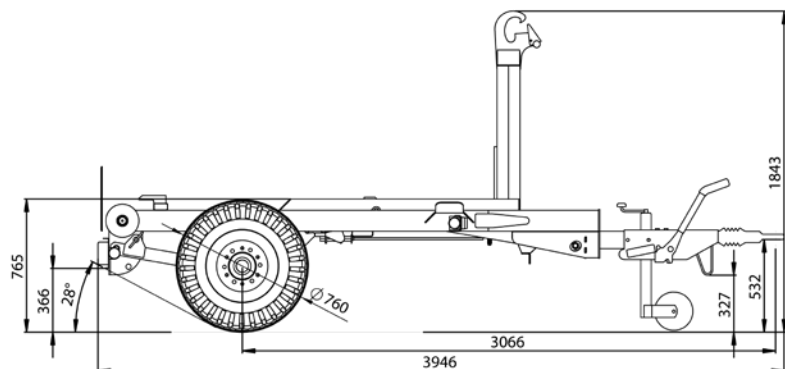

	weight/kg
1 low body	339,24
2 body	409,81
3 body 6M3	608,63
4 high body	547,46
5 body with lids	512,70
6 low body	413,14
7 body 8M3	639,24
8 sewage container	976,85
9 container with ramps	351,00

ZDV-521

PALLET STACKING DEVICE

The ZDV-521(stacker) lifting device is designed for lifting and moving pallets and loads with lifting forks and is particularly suitable for use in agriculture, horticulture, vegetable growing, construction and local transport. The device is mounted on the arms of the rear three-point hitch of a small tractor. The lifting of the suspension frame with lifting forks is carried out by a hydraulic cylinder, which is connected via a quick coupling to the external hydraulic circuit of the small tractor. The lifting is controlled by the driver from the cab. The pitch of the forks is adjusted mechanically according to the needs of the load to be lifted. The machine can be aggregated with all types of small tractors with front steerable axle equipped with a three-point hitch ISO 730/1 N. The lifting device is not suitable for articulated small tractors.

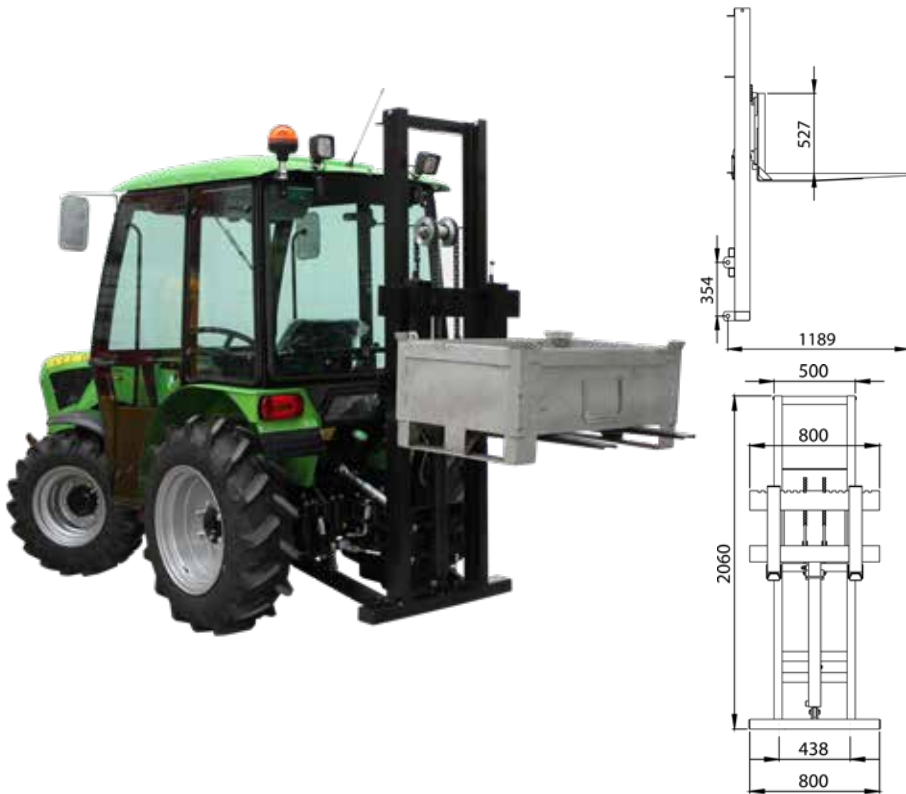

TECHNICAL DATA

length	1 230 mm	weight of lifting device	200 kg
width	1 250 mm	lifting fork spacing max.	800 mm
height	2 200 mm	maximum travel speed with load	6 km/h
load lifting height max.	2 000 mm	maximum slope accessibility	5°
load weight	300 kg		

APN-523

LOADING PLATFORM

The APN-523 loading platform is particularly suitable for agriculture, horticulture, vegetable growing, construction and local transport. It consists of forks for lifting and transporting pallets and a metal platform with side walls for transporting bulk and piece material. The loading platform can be aggregated with all types of small tractors equipped with ISO 730/1 N three-point hitch.

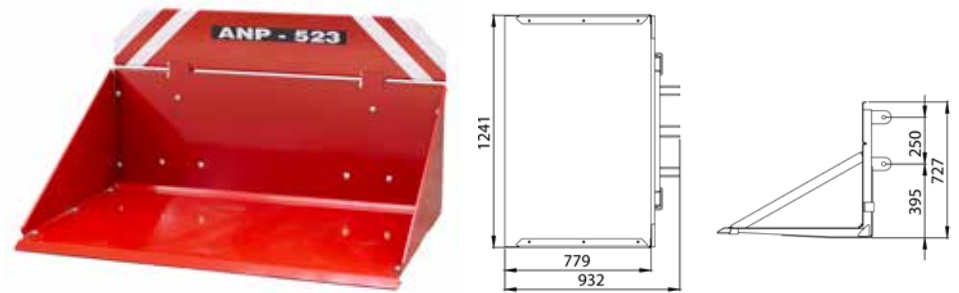

TECHNICAL DATA

length	850 mm	loading area	0,9 m ³
width	1 300 mm	fork spacing fixed	720 mm
height	720 mm	max. weight	300 kg
weight	89 kg		

PZ-200

WEIGHT 200 KG

PZ-200 weights can be attached to both front and rear three-point hitches. It is used to load the tractor in areas where it is needed. The material is cast iron. The weights can be attached to all types of small tractors.



TECHNICAL DATA

weight 200 kg
For Cat 1 and 1N suspension



LAWN MAINTENANCE

MUL-2000/1750/1500/1300/100/800 | MUL-2000/1750/1500/1300 TRAVERZ | BISON -1500/1250 |
BISON-1500UP/1250UP | SVM-1500/1300/1000 | AŽR -169 | BŽR -1600/1400/1200 |
DSF-1650 | OSP | PRV-1200/1000 |

MUL- 2000/1750/1500/1300/1000/800

MULCHERS

Mulchers are compact and versatile due to their easy handling. The mulcher hinges are variable and can be rotated 180°. This allows the mulcher to be attached to both the front and rear three-point hitch of the small tractor. It is driven by a cardan shaft with freewheel which connects the tractor drive shaft to the mulcher. The motion is transmitted to the rotor by a purpose-built belt transmission. The mulcher is equipped with a premium steel rotor that is dynamically balanced. A set of heat-treated universal blades is mounted on the rotor, which can be rotated on one side after wear, thus increasing their durability. The machine can be aggregated with all types of small tractors equipped with a three-point hitch ISO 730/1 N. For small tractors TK-12, TZ-4K-14 and MT8-132.2 it is necessary to aggregate the machine using the FDZ-187 hitch.

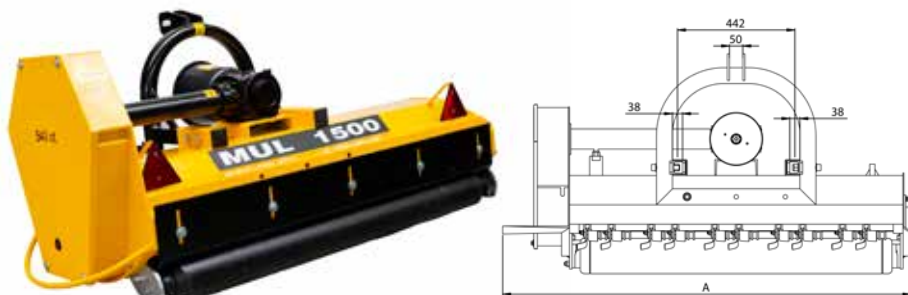

The mulchers are especially suitable for:

- area shredding
- mulching of grass, leaves, high and densely overgrown vegetation
- shredding of cut branches in orchards, vineyards and parks
- shredding of potato, corn and sunflower residues, etc.
- cleaning of parks, orchards, sports grounds, public and urban greenery

Warning! The mulcher is not intended for soil cultivation.

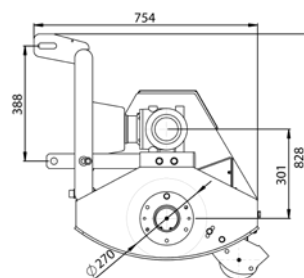

*optional installation of hammer blades

TECHNICAL DATA	MUL 800	MUL 1000	MUL 1300	MUL 1500	MUL 1750	MUL 2000
operating width	800 mm	1 000 mm	1 300 mm	1 500 mm	1 750 mm	2 000 mm
machine width (A)	1 090 mm	1 290 mm	1 540 mm	1 790 mm	1 910 mm	2 160 mm
machine height	828 mm	828 mm	828 mm	828 mm	825 mm	825 mm
machine length	754 mm	754 mm	754 mm	754 mm	760 mm	760 mm
weight	120 kg	140 kg	160 kg	180 kg	300 kg	320 kg
rotor speed	2 800 rpm	2 800 rpm	2 800 rpm	2 800 rpm	2 800 rpm	2 800 rpm
min. tractor power	10 Hp	12 Hp	16 Hp	25 Hp	30 Hp	32 Hp
PTO shaft speed	1 000 rpm	1 000 rpm	1000/540 rpm	1 000/540 rpm	1 000/540 rpm	1 000/540 rpm
number of knives	40	48	64	72	112	128

MUL-2000/1750/1500/1300

MULCHER TRAVERZ

The MUL-1300 Traverz and MUL-1500 Traverz horizontal sliding mulchers are compact and versatile machines. Their horizontal feed ensures perfect cutting of obstacles in the grassland, e.g. tree trunks, poles, curbs, etc. The mulcher is driven by an articulated shaft with a clutch which connects the tractor drive shaft to the mulcher. In aggregation with small tractors equipped with the ISO 730/1 N three-point rear hitch, they are mainly used for:

- area mulching
- mulching grass, leaves, high and densely overgrown vegetation
- shredding of cut branches in orchards, vineyards, parks, shredding of potato bundles, etc.
- cleaning of parks, orchards, sports grounds, public and urban greenery

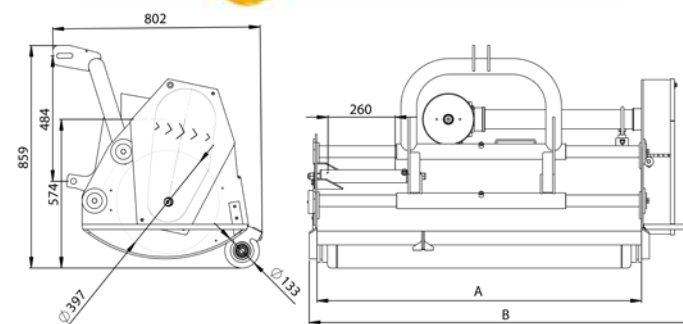

*optional installation of hammer blades

TECHNICAL DATA	1300 TRAVERZ	1500 TRAVERZ	1750 TRAVERZ	2000 TRAVERZ
operating width (A)	1 300 mm	1 500 mm	1 750 mm	2 000 mm
width (B)	1 540 mm	1 790 mm	1 910 mm	2 160 mm
machine height	859 mm	859 mm	859 mm	859 mm
machine length	802 mm	802 mm	802 mm	802 mm
weight	180 kg	200 kg	320 kg	340 kg
rotor speed	2 800 rpm	2 800 rpm	2 800 rpm	2 800 rpm
min. tractor power	16 Hp	25 Hp	30 Hp	32 Hp
PTO shaft speed	1 000/540 rpm	1 000/540 rpm	1 000/540 rpm	1 000/540 rpm
number of knives	64	72	112	128

BISON-1500/1250

MULCHER WITH COLLECTION

The BISON 1250 and BISON 1500 mulchers are compact and versatile machines. The mulchers are equipped with a premium steel rotor that is dynamically balanced. The rotor is equipped with 40 or 72 heat-treated blades, which are shaped to produce a better suction effect and a more perfect filling of the collection basket. The tipping and closing of the basket is controlled hydraulically directly from the small tractor. The hydraulic cylinder is double-acting, which allows the basket to be left open and thus not collect the crushed material. The mulchers are driven by an articulated shaft with a timing clutch that connects the tractor drive shaft to the mulcher. In aggregation with small tractors equipped with ISO 730/1 three-point rear hitch and power exceeding 25 kW

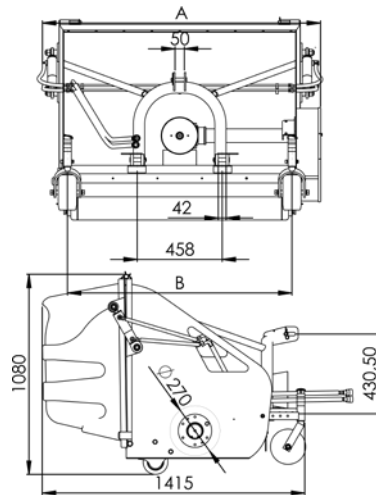

Mulchers are particularly suitable for:

- for area mulching with the possibility of collection (the collected grass can be used for feeding)
- mulching of grass, leaves, tall and densely overgrown vegetation - collection of leaves, grass and similar grass deposits
- cleaning of parks, orchards, sports grounds, public and urban greenery - shredding and collection of potato peelings

Warning! The mulcher is not intended for soil cultivation.

TECHNICAL DATA / BISON 1250

working width	1 250 mm	number of blades	40 pcs
basket volume	700 l	slope inclination	12°
weight	220 kg	working speed	to 3 km/h
PTO speed	540 or 1000 rpm	machine width	1 480 mm
energy source	16 HP	machine height	1 700 mm
		machine length	1 450 mm

BISON-1500UP/1250UP

MULCHERS WITH COLLECTION AND LIFTING

The BISON UP 1250 and BISON UP 1500 collection and lifting mulchers are compact and versatile machines. The mulchers are equipped with a premium steel rotor that is dynamically balanced. The rotor is fitted with 40 or 72 heat-treated blades, which are shaped to produce a better suction effect and a more perfect filling of the collection basket. The tipping and closing of the basket is controlled hydraulically directly from the small tractor. The hydraulic cylinder is double-acting, which allows the basket to be left open and thus not collect the crushed material. The mulcher is driven by an articulated shaft with a timing clutch which connects the tractor drive shaft to the mulcher. In aggregation with small tractors equipped with ISO 730/1 three-point rear hitch and power exceeding 25 kW.

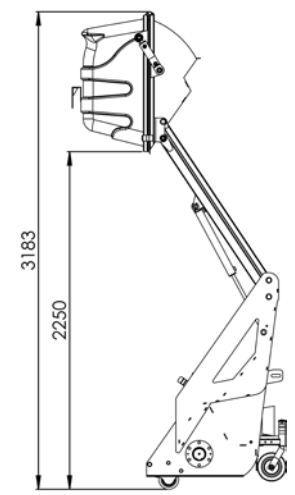
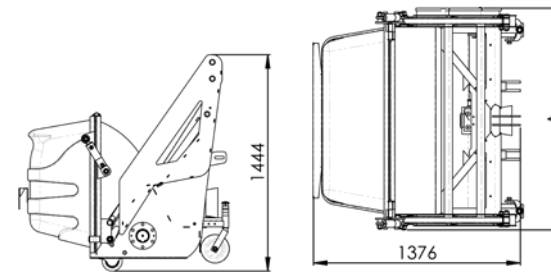

TECHNICAL DATA / BISON 1500

working width	1 500 mm	number of blades	48 pcs
basket volume	1 000 l	slope inclination	12°
weight	250 kg	working speed	to 3 km/h
PTO speed	540 or 1000 rpm	machine width	1 650 mm
energy source	25 HP	machine height	1 700 mm
lifting height	2.18 m	machine length	1 450 mm

SHEEP-3500/3000

DITCH MULCHERS

Ditch mulchers are primarily designed for mowing and mulching inaccessible maintained and unmaintained grass areas such as ditches, islands, etc. The equipment is mounted on the rear three-point hitch arms of the small tractor and is powered by a hydromotor included in the machine. The hydraulic motor is driven by a PTO shaft from the small tractor. A set of heat-treated universal blades is mounted on the rotor, which can be rotated on one side after wear, thus increasing their durability. The machine can be aggregated with all types of small tractors equipped with a three-point hitch of category ISO 1 and with a PTO speed of 540 rpm-1.

- Spring-loaded anti-shock lock on the second arm
- Reversing rotor operation

Control options:

Joystick or levers via tractor-mounted switchboard. (Tractor must be equipped with 3 hydraulic circuits)

* **Optional:** Independent joystick control located on the mulcher.

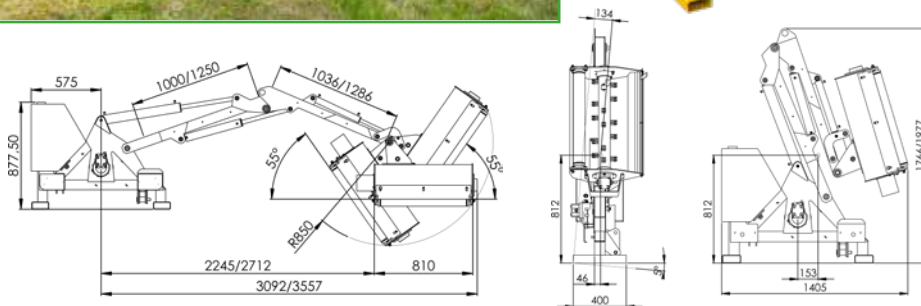

TECHNICAL DATA

working width	800 mm	min. weight of tractor	800 kg
number of blades	40	min. wheelbase of tractor	100 mm
max. operating radius	3 090 mm	hydraulic oil tank	70 l
weight	320 kg	spring-loaded impact lock on the second arm control	
min. wheel track of tractor	25 HP	via joystick of the small tractor directly from the driver	

SVM-1500/1300/1000

SLOPE MULCHERS

Slope mulchers are primarily designed for mowing and mulching inaccessible maintained and unmaintained grass areas such as ditches, islands, etc. The equipment is mounted on the arms of the rear three-point hitch of the small tractor. The SVM 1300 is driven by a PTO shaft from the small tractor. A set of heat-treated universal blades is mounted on the rotor, which can be rotated on one side after being used, thus increasing their durability. The machine can be aggregated with all types of small tractors equipped with a three-point hitch of category ISO 1 and with a PTO speed of 540-1000 rpm.

Control via a four-section hydraulic distributor or the Joystick of the small tractor directly from the driver's seat.



TECHNICAL DATA

	SVM-1000	SVM-1300	SVM-1500
working width	1 000 mm	1 300 mm	1 500 mm
number of blades	48	64	80
minimum output of tractor	25 HP	35 HP	45 HP
minimum weight of tractor	800 kg	800 kg	800 kg
minimum wheel track of tractor	100 mm	100 mm	100 mm
weight	230 kg	250 kg	270 kg

AŽR-169

ROTARY MOWER

The AŽR-169 rotary mower is a front aggregation tool for small tractors equipped with ISO-730/1 N front three-point hitch, including front PTO shaft. It is driven by a cardan shaft that connects the tractor drive shaft to the mower. It is a robust and versatile machine particularly suitable for mowing maintained grassland in playgrounds, parks, gardens, public lawns, etc., throughout the growing season.

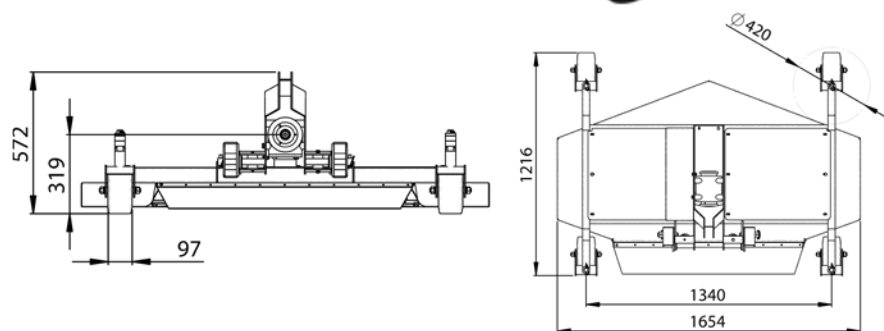

TECHNICAL DATA

machine width	1 654 mm	number of rotating blades	3 pcs
machine length	1 235 mm	working width	1 600 mm
machine height	585 mm	working speed	to 3 km/h
machine weight	170 kg	stubble height range	20-70 mm
energy source	min. 14.5 kW	height of the stubble before mowing	200 mm
PTO speed	1 000 rpm	slope inclination	10°

SB-1400/1200/1000

ROTARY TWO-DRUM REAR MOWER

The SB-1200 side mower is designed for mowing tall grass and soft-bladed plants up to a height of approx. 500 mm. The torque transmission is carried out by connecting the mower drive shaft to the PTO shaft of the small tractor by means of an articulated shaft with freewheel from where it is transmitted by means of a 6-sided V-belt to the counter-rotating knife drums of \varnothing 600 mm. The machine moves freely in the working position on the rotating sliding discs, which, together with the low weight of the mower, ensure perfect ground following. To prevent overloading or hitting a rigid obstacle, the mower is equipped with a strut with spring lock, which allows the machine to swing out in the event of an impact and thus prevents damage. The mower is equipped with a cable lifting mechanism that allows it to be lifted in the working position and repositioned in the transport position using the hydraulics of the small tractor linkage. The side-mounted machine can be aggregated with all types of small tractors equipped with a three-point hitch ISO 730/1 N. For TK-12, TZ-4K-14 and MT8-132.2 small tractors, the machine must be aggregated using the FDZ-187 hitch.



TECHNICAL DATA	SB-1000	SB-1200	SB-1400
working width	1 000 mm	1 200 mm	1 400 mm
number of blades	6	6	6
stubble height	40 mm	40 mm	40 mm
drum speed	1 800 rpm	1 800 rpm	1 800 rpm
drum diameter	500 mm	600 mm	700 mm
working capacity	0.5-0.8 ha/h	0.7-1 ha/h	0.9-1.2 ha/h
PTO speed	540 or 1 000 rpm	540 or 1 000 rpm	540 or 1 000 rpm
weight	105 kg	110 kg	210 kg

BŽR -1600/1400/1200

FRONT ROTARY DRUM MOWERS

The BŽR front rotary two-drum mower is designed for mowing tall grass and soft-woody plants up to a height of approx. 500 mm. The machine is connected to a small tractor by means of a DRZ-103 quick coupling. The transmission of torque is carried out by connecting the drive shaft of the mower to the PTO shaft of the small tractor by means of an articulated shaft with freewheel, from where it is transmitted by means of a 6-sided V-belt to the counter-rotating knife drums with a diameter of 600 mm.

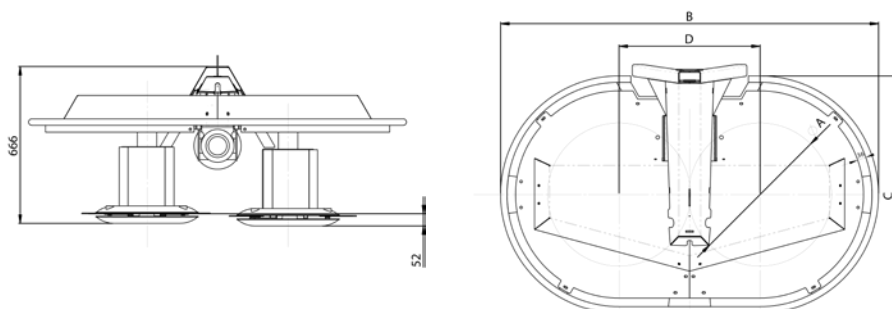

TECHNICAL DATA

	BŽR-1200	BŽR-1400	BŽR-1600
operating width	1 200 mm	1 400 mm	1 600 mm
number of knives	2 x 3	2 x 3	2 x 3
drum speed	approx 1 800 rpm	approx 1 800 rpm	approx 1 800 rpm
stubble height	52 mm	52 mm	52 mm
drum diameter (A).....	608 mm	708 mm	808 mm
max. speed according to tractor type	8 km/h	8 km/h	8 km/h
max. working power according to tractor type.....	approx 0,7-1 ha/h	approx 0,9-1,2 ha/h	approx 1,1-1,4 ha/h
machine weight.....	158 kg	182 kg	192 kg
machine width (B).....	1 607 mm	1 807 mm	2 007 mm
machine length (C).....	1 007 mm	1 107 mm	1 207 mm
Rotor pitch (D).....	600 mm	700 mm	800 mm

DSF-1650

FRONT DISC MOWER

The DSF-1650 front or side-mounted disc mower is designed for mowing tall grass and soft-bladed plants up to a height of 300 to 500 mm on moderately flat and moderately curved surfaces with a maximum slope of up to 12° (depending on the tractor). The mower can be aggregated with tractors over 26 kW equipped with a front three-point hitch. The mower is driven by the tractor's PTO shaft, the speed of which should be between 820 and 1000 rpm (540 min-1). The drive of the mower is provided by a modified PTO shaft with freewheel.



TECHNICAL DATA

width	1 900 mm	cutting height.....	60 mm
length	1 220 mm	PTO speed	820-1 000 rpm
height	865 mm	max. working speed.....	8 km/h
hmotnost stroje	220 kg	max. working power	0,7-1 ha/h
operating width	1 650 mm	max. transport speed	15 km/h
number of working discs	4	traktor type	over 26 kW
number of knives	4 x 2	tractor axle track	max. 1 500 mm
working width.....	1 600 mm	slope accessibility.....	12°
working disc speed	cca 2600 rpm		

OSP-1500/1850/2250

COMBINATED HAY MAKER

The forage tedder and raker is used for raking, turning forage, raking out leaves, moss, etc. When turning the forage, the row shield is removed and the moving speed and the rotation speed of the raking belt are selected so that the forage is properly distributed. The forage is rowed with the shield and, in the case of large quantities of forage, without the shield. Torque transmission is carried out by connecting the PTO shaft of the tedder to the PTO shaft of the small tractor by means of an articulated shaft. The machine can be aggregated with all types of small tractors fitted with a three-point hitch.

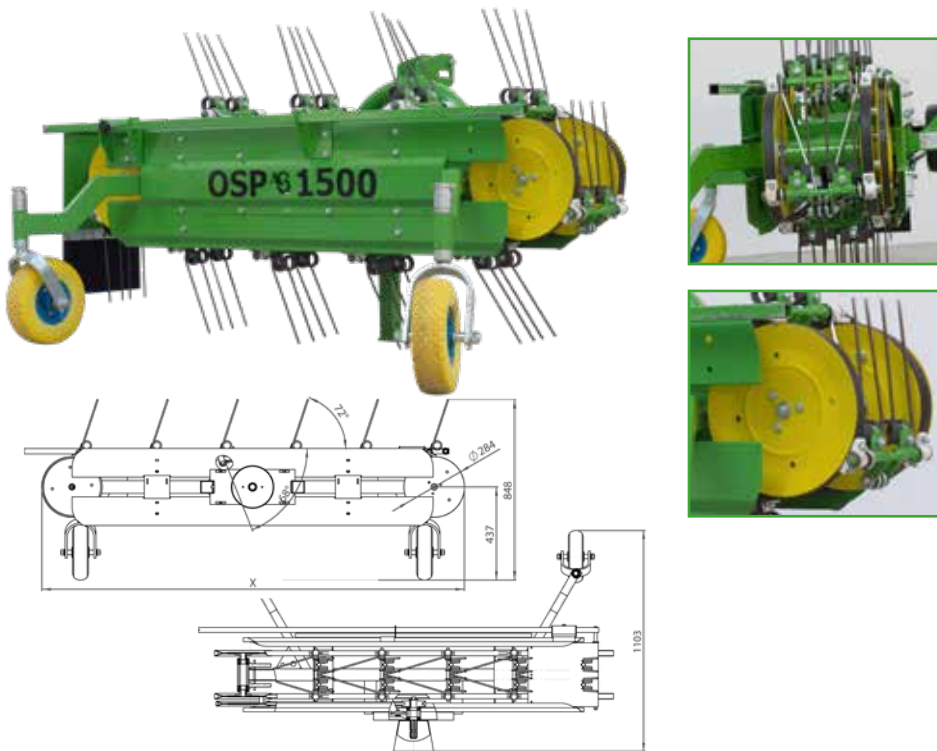

TECHNICAL DATA	OSP-2250	OSP-1850	OSP-1500
machine length	1 102 mm	1 102 mm	1 102 mm
machine width (x)	2 408 mm	1 980 mm	1 650 mm
machine height	848 mm	848 mm	848 mm
machine weight	110 kg	80 kg	100 kg
working width	2 480 mm	1 980 mm	1 650 mm
number of rakes	16	13	11
max. working speed.....	max 6 km/h	max 6 km/h	max 6 km/h
Input shaft speed	400-700 rpm	400-700 rpm	400-700 rpm
power	0,8-0,85 ha/h	0,4-0,45 ha/h	0,6-0,65 ha/h

PRV-1200/1000

AERATING ROLLERS

The PRV-1000 and PRV-1200 aerating rollers are particularly suitable for applications where the high quality of the lawn area is essential, such as football pitches, castle parks, etc. They are used for effective aeration of lawn areas. Depending on the hardness of the surface, the weight of the roller can be increased by filling with water through two pouring holes. The aeration roller is designed for all types of small tractors and lawn tractors. Pulled and carried version.

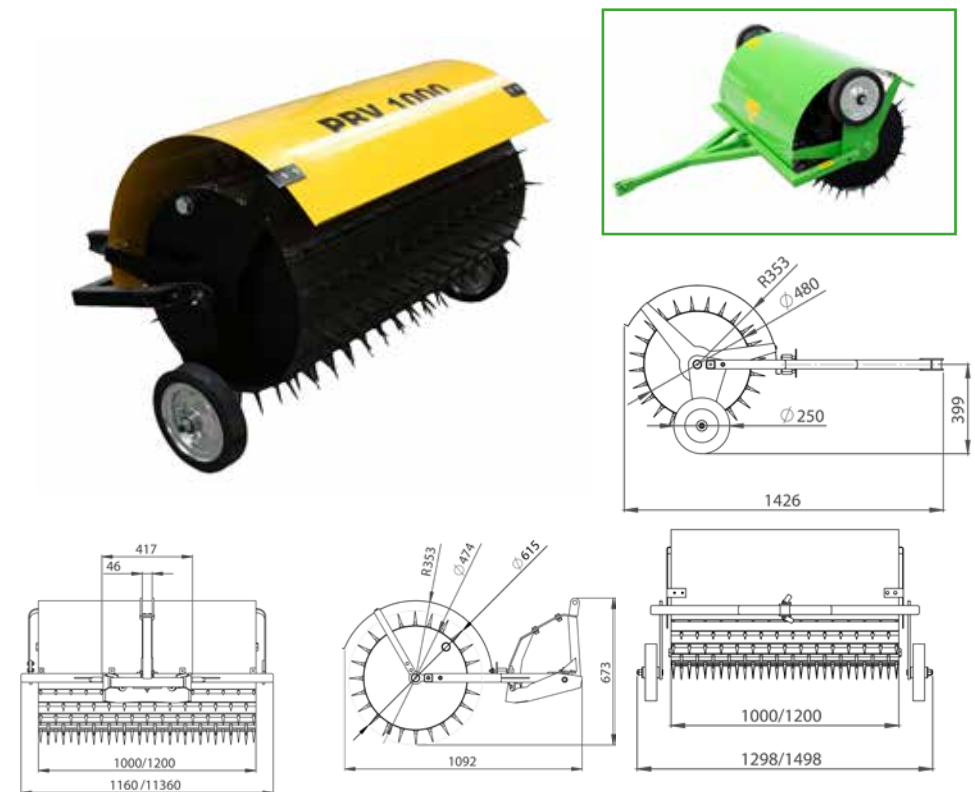

TECHNICAL DATA	PRV-1000	PRV-1200
roller diameter	500 mm	500 mm
roller length	1 000 mm	1 200 mm
tip length	60 mm	60 mm
width	1 116 mm	1 360 mm
height	670 mm	670 mm
length	1 100 mm	1 100 mm
weight/according to the filling.....	80/280 kg	100/311 kg





SOIL CULTIVATION

AKR-140/120/100 | AKP-122 | AKM-172/130 | PB4-144.4 | PON-25A |
PN3-300/PN2-300 | PON2-250 H | PON2-300 H | SK2-130 | FRA-003 | FRA-005 | AVB-568 | APV-175 |
PBG-250 | VHN-1200/1000 | TB-120/100 |

AKR-140/120/100

ROTARY TILLERS

The rotary tiller provides mechanisation of work on small areas of agricultural land and in municipal services. It is particularly suitable for vegetable growing, nursery and orchard farming, for pre-sowing soil preparation, for mixing topsoil with compost or manure, for weed control and hoeing of broad-row crops. For small tractors with lower power not exceeding 14HP, i.e. TZ-4K-14 and TK-10, the AKR-100 rotary tiller with a smaller reach of 100 cm has been developed. The cultivator can be aggregated with all types of small tractors equipped with a three-point hitch ISO 730/1 N. For small tractors TK-12, TZ-4K-14 and MT8-132.2 it is necessary to aggregate the machine using the hitch FDZ-187. The tiller draws torque from the rear PTO shaft of the small tractor by means of an articulated shaft.

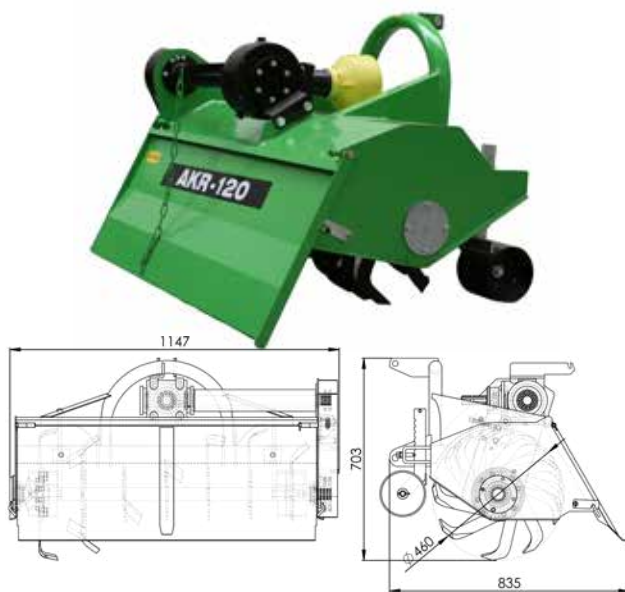

TECHNICAL DATA	AKR-140	AKR-120	AKR-100
machine length	870 mm	870 mm	870 mm
machine width	1 500 mm	1 355 mm	1 140 mm
working width	1 360 mm	1 150 mm	1 000 mm
working depth	150 mm	150 mm	150 mm
machine height	770 mm	770 mm	690 mm
number of blades	27L + 27R	24L + 24R	14L + 14R
slope inclination	8°	8°	8°
PTO shaft speed	540 or 1000 rpm	540 or 1000 rpm	540 or 1000 rpm
weight	184 kg	164 kg	120 kg

AKP-122

SUBSOILER

The machine is designed for loosening smaller areas to prepare the soil for plant cultivation. Aggregation behind small tractors with the help of triangular quick hitch DZR-103, DZR-203 and RZ-1.

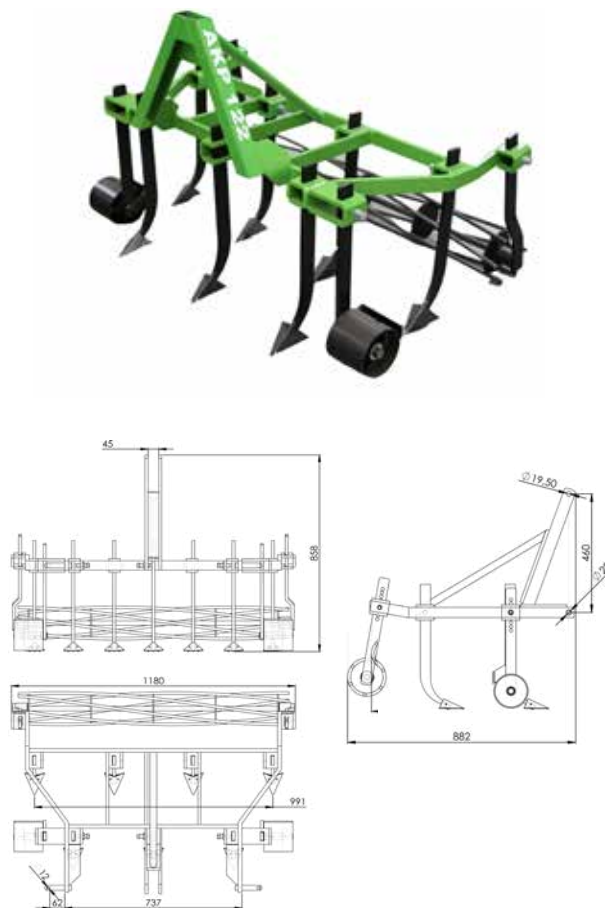

TECHNICAL DATA

machine width	860 mm
machine height	700 mm
machine length	1 250 mm
weight	110 kg

AKM-172/130

COMBINATORS

The AKM-172 is designed for soil preparation after autumn ploughing before sowing and planting, for surface ploughing, lump crushing and levelling of the plot surface with a rod drum, ploughing furrows for hand planting of potatoes, vegetables, incorporation after planting, ploughing during vegetation and ploughing at harvest. The machine can be aggregated with all types of small tractors equipped with three-point hitch ISO 730/1 N. For small tractors TK-12, TZ-4K-14, MT-132.2 it is necessary to aggregate the machine with hitch FDZ-187.

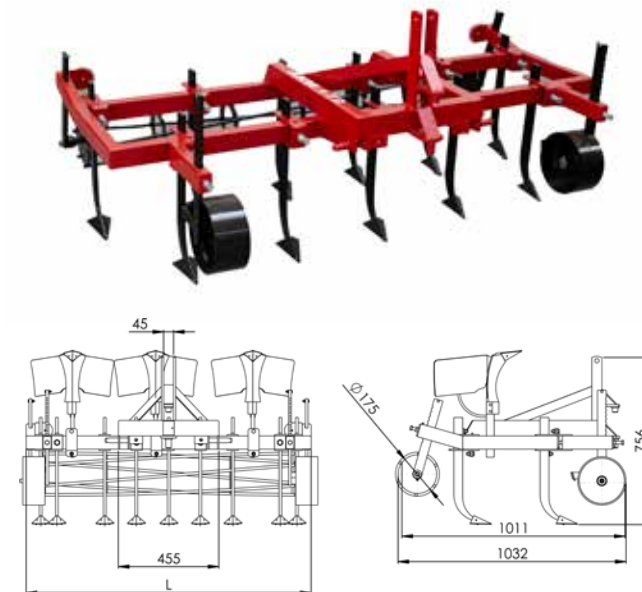

TECHNICAL DATA

	AKM-172	AKM-130
machine width	1 860 mm	1 400 mm
machine length	950 mm	950 mm
machine height	810 mm	810 mm
weight	150 kg	125 kg
loosening working width	1 620 mm	1 130 mm
loosening depth	up to 150 mm	up to 150 mm
row spacing for planting potatoes	550 mm	550 mm
working speed	to 5 km/h	up to 5 km/h
slope inclination for aeration	up to 8°	up to 8°
slope inclination for grooving	up to 4°	up to 4°

PB4-144.4

TWO-PART HARROWS

The PB4-144.4 two-part soil harrow is primarily used for seedbed preparation, as well as for soil compaction, soil loosening, field levelling and weed control. The harrows consist of two harrow bays, a support frame and a levelling plate. The gate sections are suspended from the harrow by chains.

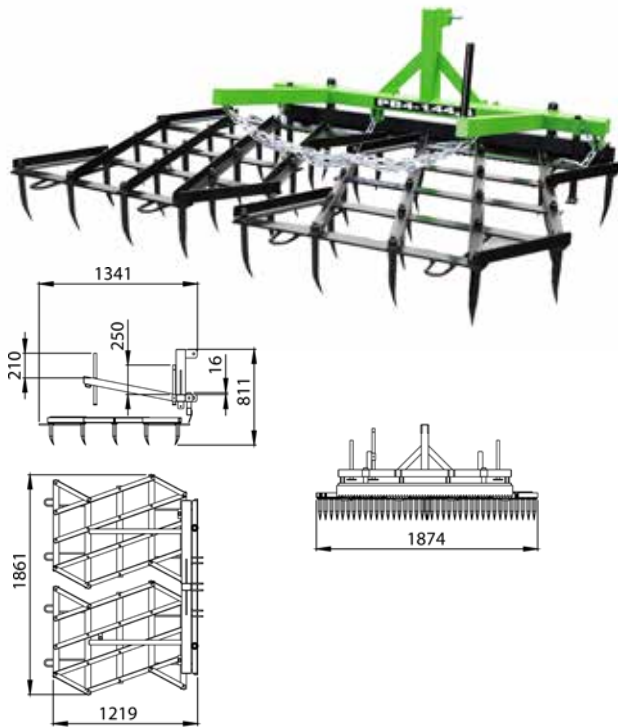

TECHNICAL DATA

width	1 900 mm
length	700 mm
working width	1 870 mm
weight	94 kg
spike length	100 mm
number of spikes in one section	20

PON-25A

ONE FURROW REVERSIBLE PLOUGH

The PoN-25-A plough is suitable for medium ploughing on smaller agricultural areas. It has proven itself in ploughing in gardens and orchards, nurseries, horticulture, etc. The plough can be used for ploughing up a slope of up to 6°, when ploughing with the right and left body without storage, or for ploughing permanently on one side. Both left and right disc coulters are supplied with the plough. The accessory of the small tractor includes a head to which the plough is attached. The plough is suitable for small tractors with category 1 and 1N hitch using frame hitch S0554 and complete swivel head.

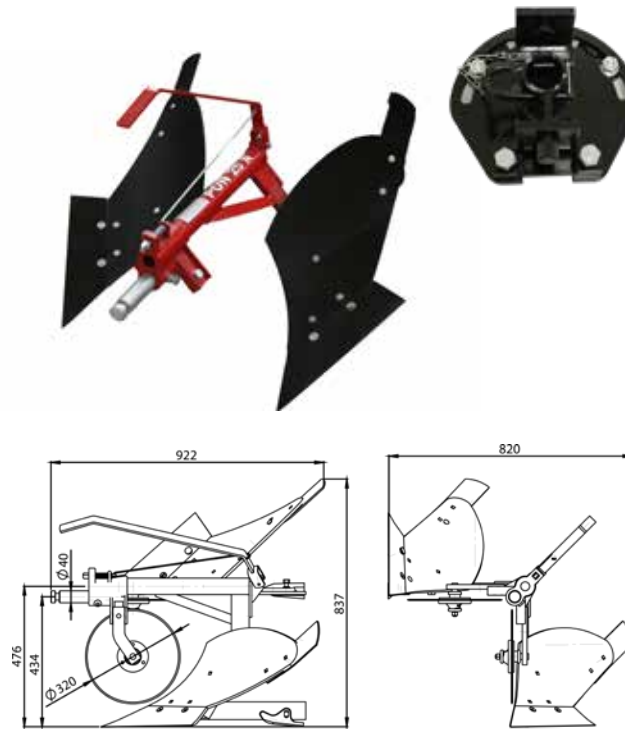

TECHNICAL DATA

working width	250 mm
slope inclination	max 6°
weight	77 kg
max. ploughing depth	220 mm

PN3-300/PN2-300

TWO-/THREE-FURROW ONE-SIDED PLOUGH

The two- or three-furrow mounted plough is suitable for medium ploughing and cultivation in small plots, gardens, greenhouses and orchards. The plough is equipped with a device that allows more precise adjustment of the plough. To adjust the ploughing depth, the plough is equipped with a depth wheel. The coulters are secured with bolts that break when hitting an obstacle. The machine can be aggregated with all types of small tractors fitted with the ISO 730/1 N three-point hitch.

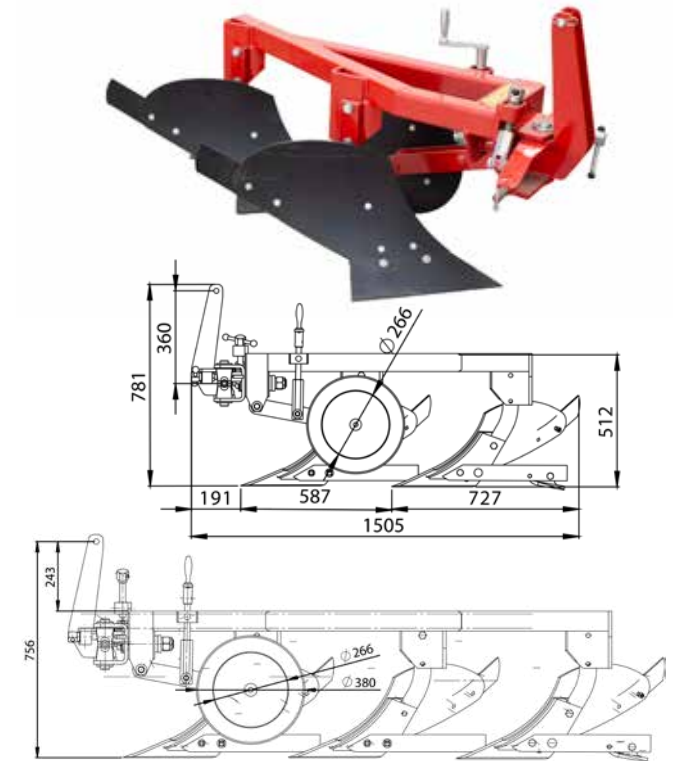

TECHNICAL DATA

	PN2-300	PN3-300
length	1 505 mm	2 084 mm
width	772 mm	1 032 mm
height	781 mm	756 mm
working width	510 mm	80 mm
max. ground inclination	+/- 12°	+/- 12°
weight	126 kg	161 kg
max. ploughing depth	220 mm	220 mm

PON2-250 H

TWO-ROW REVERSIBLE PLOUGH

The two-row plough is suitable for medium ploughing and cultivation on small plots, in gardens, greenhouses and orchards. The plough is equipped with a device that allows more precise plough adjustment. To adjust the ploughing depth, the plough is equipped with a depth wheel. The blades are secured with bolts that break when they hit an obstacle. The machine can be aggregated with all types of small tractors equipped with a three-point hitch ISO 730/1 N. For lighter soil, the TZ-4K-14 small tractor can be used.

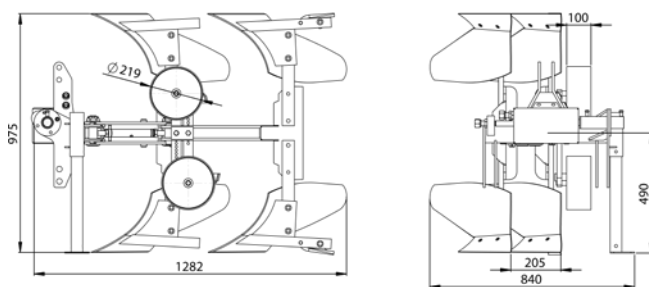

TECHNICAL DATA

working width.....	400 mm
slope inclination	6°
weight	115 kg
max. ploughing depth	220 mm

PON2-300 H

TWO-ROW REVERSIBLE PLOUGH

The two-row plough is suitable for medium ploughing and cultivation on small plots, in gardens, greenhouses and orchards. The plough is equipped with a device that allows more precise plough adjustment. To adjust the ploughing depth, the plough is equipped with a depth wheel. The machine can be aggregated with all types of small tractors equipped with a three-point hitch ISO 730/1 N.

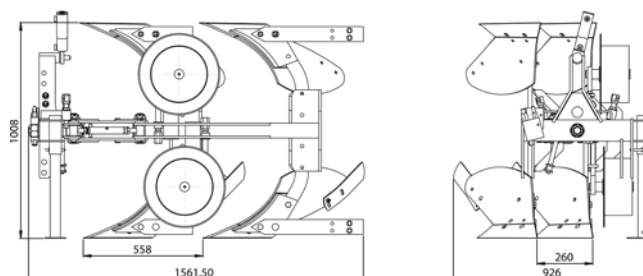

TECHNICAL DATA

length	1 000 mm	weight	120 kg
width	450 mm	working width	500 mm
max. depth	220 mm	max. slope inclination	+/- 12°

SK2-130

TWO-LINE POTATO PLANTER

The machine is designed for planting unsprouted or sprouted potatoes (sprouts up to 5 mm). The machine creates furrows, places the tubers in them and covers them. Only a two-axle small tractor can be used as a tractor. The machine can be aggregated with all types of small tractors equipped with a three-point hitch ISO 730/1 N. For small tractors TK-12, TZ-4K-14, MT-132.2 the machine must be aggregated with a hitch FDZ-187.



TECHNICAL DATA

machine width	1 460 mm
machine length	1 250 mm
machine height.....	1 040 mm
weight	175 kg
line spacing options	560 mm
number of furrows	2
spacing of potatoes in furrow	26-30-33-37 cm
planting depth (from the original field surface)	4-8 cm
feeding hopper capacity	up to 120 kg
working speed	2-5 km/h
max. slope inclination	6°
transport speed	up to 15 km/h
machine output (in good conditions)	0,25 ha/h
tractive power	small tractors MT8-050, MT8-150 TZ-4K14, MT8-132

FRA-003

THREE FURROW RIDGER FRAME

The equipment is designed for preparing the soil for planting potatoes and for harrowing the soil during potato cultivation. The row width is adjustable up to the maximum width of the frame. For use behind small tractors with ISO 730/1 three-point rear hitch.



TECHNICAL DATA

length	1 500 mm	weight	80 kg
width	500 mm	max row spacing	725 mm
height	700 mm		

FRA-005

FIVE FURROW RIDGER FRAME

The equipment is designed for preparing the soil for planting potatoes and for harrowing the soil during potato cultivation. The row width is adjustable up to the maximum width of the frame. For use behind small tractors with ISO 730/1 three-point rear hitch.



TECHNICAL DATA

length	1 500 mm	weight	80 kg
width	500 mm	max row spacing	725 mm
height	700 mm		

AVB-568

POTATO DIGGER

The AVB-568 potato digger is used exclusively for digging out potatoes, separating them from the soil and placing them on the surface of the ploughed row in such a way that they cannot be damaged or buried when the next row is ploughed. Ploughing the next row is therefore not dependent on picking up the rows already ploughed, which results in a high efficiency of use of the plough. The coupling of all small tractors is carried out directly by means of a three-point hitch. The torque transmission is achieved by coupling the plough drive shaft to the PTO shaft of the small tractor by means of an articulated shaft. The machine can be aggregated with all types of small tractors equipped with a three-point hitch ISO 730/1 N. For small tractors TK-12, TZ-4K-14 and MT8-132.2 it is necessary to aggregate the machine using the FDZ-187 hitch.

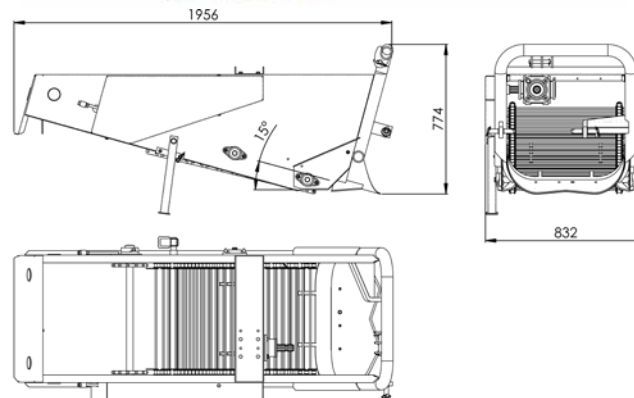

TECHNICAL DATA

length	1 925 mm	ploughing depth	to 120 mm
width	840 mm	working speed	1,5 - 3 km/h
height	900 mm	max. slope	6°
weight	180 kg	input shaft speed	130 - 650 rpm
scope	1 row	power	0,1 - 0,28 ha/h

APV-175

SOIL AUGER

The APV-175 soil auger is used to drill a hole in cohesive soil without large stones. This facilitates work when planting trees or shrubs, setting fence posts or similar work. The machine is based on a U-shaped support frame. A gearbox with a pair of toothed bevel gears is swivel mounted at the end of the frame. A drill bit is attached to the output shaft of the gearbox. The pinion is driven from the tractor by an articulated shaft. The support frame is attached to the tractor in place of the third point and the support to the lower arms. The diameter of the drill hole is determined by the diameter of the drill bit. The machine is equipped with drill bits with diameters of 150,200,300,400 and 500 mm. The depth of the drill pits is adjusted by means of adjustable operators on the gearbox. The machine can be aggregated with all types of small tractors equipped with three-point hitch ISO 730/1 N. For small tractors TK-12, TZ-4K-14, MT-132.2 it is necessary to aggregate the machine by means of hitch FDZ-187. The machine can be mounted to the rear or front hitch. The soil drill has a low operation and maintenance requirements by its design.

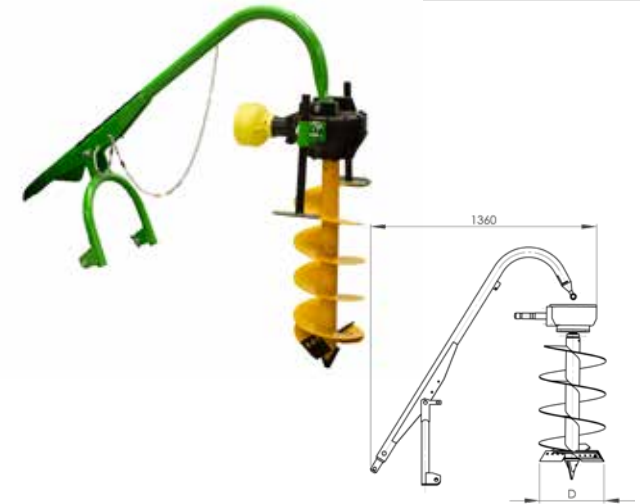

TECHNICAL DATA

distance between drilling axis and rear wheel axis	1 800 mm
weight	167kg
max. bore depth	700 mm
drill diameters	150/200/300/400/500 mm
rated drilling speed	121 rpm
input shaft speed	540 rpm

PBG-250

REAR DIGGER

The machine is used for excavation work and handling of agrarian materials. This equipment is mobile and is stabilised on fixed, adjustable supports during work. If the power of the tractor's hydraulic motor is not sufficient, there is the possibility of adding a separate hydraulic circuit at an additional cost. This circuit is driven by a hydraulic motor located on the tractor output shaft and is controlled by an independent dual-function distributor. This machine is reliable and easy to operate. Quick connection and disconnection are a common feature.

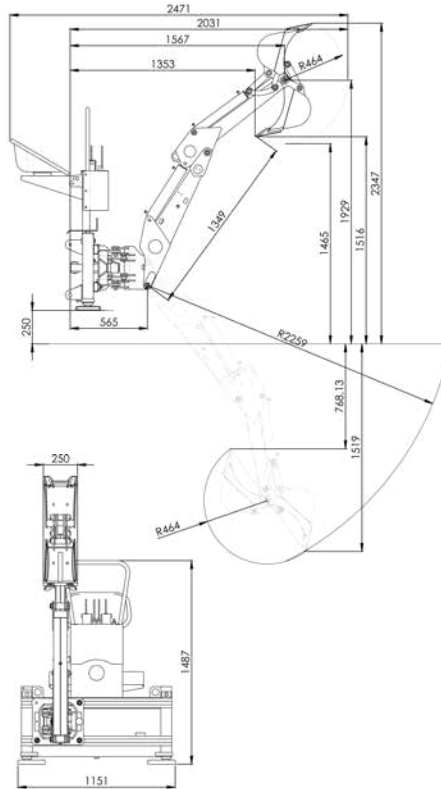

TECHNICAL DATA

max. angle of rotation..... 180°
 max. weight on hook 150 kg
 max. hydraulic pump output 25 l/min
 loading scoop volume 0.03 m³
 hydraulic tank volume 25 l
 hydraulic working pressure 16 MPa
 option of wider bucket scoop 400 mm volume 0.05 m³
 slope scoop bucket 800 mm wide

VHN-1200/1000

SMOOTH/CARRIED AND PULLED LAND ROLLER

The VH-1000 smooth land roller is primarily used for compacting soil, sand, gravel, etc. It is particularly suitable for agriculture, horticulture, vegetable growing, construction and local transport. According to the hardness areas, the weight of the roller can be increased by filling with water or sand, two pouring holes. The cylinder can be aggregated with all types of small tractors equipped with ISO 1 three-point hitch.



TECHNICAL DATA	1000	1200
cylinder diameter	500 mm	500 mm
cylinder length.....	1 000 mm	1 200 mm
width.....	1 116 mm	1 360 mm
height.....	610 mm	670 mm
length.....	1 100 mm	1 100 mm
weight/by filling.....	75/275 kg	100/311 kg

VHN 1200 - carried/pulled variant.

TB-120/100

DISC HARROWS

Used for quality soil preparation before sowing, planting and stubble cultivation. Very successfully used in green manuring. It finds its application in vineyards and hop gardens.



TECHNICAL DATA

width TB 1000.....	1 000 mm	construction.....	metal
width TB 1200.....	1 200 mm	plate diameter	360 mm
length.....	1 300 mm	weight	180 kg
height.....	600 mm		



FORESTRY

TSM-95 | 35E/30E | TSH -120 | BOBR-75 | RAM-1000 | ŠŠ-1000 |

TSM-90

MECHANICAL WOOD CHIPPER

The tractor chipper is intended for the disposal of materials of plant origin, plant residues, woody parts up to the maximum diameter of the inserted material of 120 mm, by refining it into particles suitable for subsequent use of chips for heating, production of mulch for backfilling plants, or for the treatment of plant residues before composting. The chipper can be applied behind a small tractor by means of a three-point hitch of category 1 and 1 N. The chipper is equipped with a mechanically rotating chimney, which ensures that the chips are discharged directly onto the bucket. The chipper takes torque from the PTO of the small tractor by means of an articulated shaft.

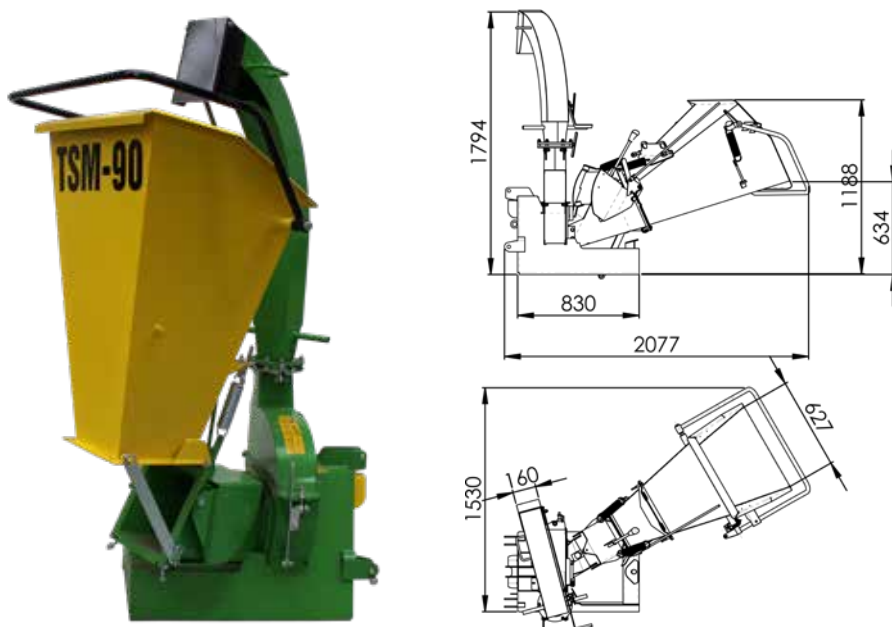

TECHNICAL DATA

blade diameter.....	570 mm
number of blades	4
blade size	170 x 100 x 14
rotor speed	800 rpm
weight	280 kg
chip size	5-15 mm
capacity.....	5-10 m³/h
max. diameter of branches	120 mm
tractor power	25-50 HP
PTO speed	1 000 rpm
three-point hitch	category 1 and 1N
funnel directional rotation	180°- 7 positions
inserted profile (width x height)	622 x 622 mm



TSH -120

WOOD CHIPPER WITH HYDRAULIC FEEDING

The TSH-120 chipper is equipped with a hydraulically driven loading cylinder with nostress system, which ensures smooth operation by automatically regulating the chipped material towards the cutting disc. The hydraulic feeding device has automatic feeding, neutral and reversal modes. The chipper takes torque from the PTO shaft of the small tractor by means of an articulated shaft.

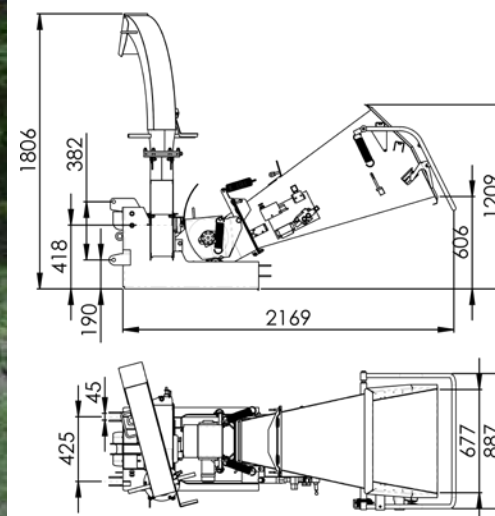

35E/30E

MECHANICAL FORESTRY WINCH UNIFOREST

The winch is designed primarily for forestry work to bring logs closer. The machine consists of a welded steel structure, main shaft, chain wheel with clutch, drum with steel cable, brake and directional pulley. The winch is driven by an articulated shaft which connects the tractor drive shaft to the winch. The machine can be aggregated with all types of small tractors fitted with ISO 730/1 three-point hitch with a PTO speed of 540 rpm.



TECHNICAL DATA

	30E	35E
pulling power.....	30 kN	35 kN
mean rope speed.....	0,8 m/s	0,9 m/s
rope length/diameter	10 m/50 mm	10 m/70 mm
small tractor power	16-34 HP	16-45 HP
width	1 000 mm	1 200 mm
length	420 mm	450 mm
height without bars/with bars..	1 060/2 000 mm	1 160/2 000 mm
weight	185 kg	245 kg
hinge category	I	I, II
control.....	mechanical	mechanical

RAM-1000/1000H

TIMBER BLADE/WITH HOLDING DEVICE

The RAM-1000 device is used for handling logs and tree trunks. For the application of the ramp to a small tractor, it is necessary that the small tractor is equipped with a front three-point hitch category 1 N. The low timber blades of Šálek s.r.o. are designed for those who do not take advantage of high or semi-high timber blades. The low timber blade of our own design with a holding finger is manufactured to the highest standards of the company Šálek. The robust construction resists the maximum load when ramping. The entire timber blade is simply operated by a control in the tractor, which is designed to control the external hydraulic circuit



TECHNICAL DATA

length	1 016 mm
height	506 mm
weight	78 kg

ŠŠ-1000

SCREW WOOD SPLITTER

The screw splitter is used for splitting wooden logs from 10 cm to 100 cm in length. Splitting is achieved by rotating the splitting mandrel with a helix (asymmetrical thread), whereby the piece of wood is drawn in by the thread until the log is split. The splitter has two working positions. For splitting a log from 10 cm to 40 cm long, a work table is used and from 40 cm to 100 cm long the work table is removed and a support is used. The splitter mandrel is made of high quality hardened steel and can be sharpened or simply replaced at any time. The screw splitter can be mounted behind small tractors with ISO 730/1 N three-point hitch.

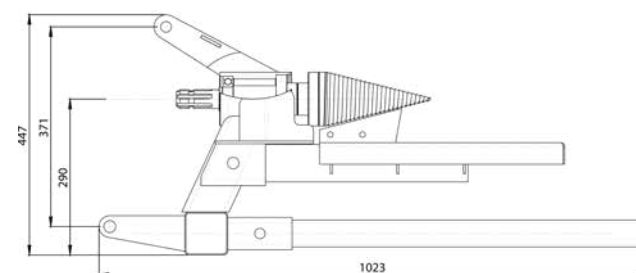

TECHNICAL DATA

diameter of splitting mandrel.....	100 mm
splitting mandrel speed	500-1 000 ot/min
input power requirement	min. 10 kW
weight	50 kg

BOBR-75/ BOBR-75 TRANSPORT

WOOD CHIPPER

The BOBR 75 and BOBR 75 T wood chippers are used for the disposal of wood (branches, whole trees, etc.) after logging, pruning and cleaning of forests, parks, gardens and river basins or for the processing of construction or carpentry waste. The result of the splitter's work is firewood cut into 6 to 10 cm pieces up to a maximum of *80 mm. The logs are suitable for all solid fuel heaters after drying. The splitter is equipped with two three-legged drums connected by gears. When rotating, the blades of the pair of knives are brought to a minimum distance (0.2 mm) to each other and pressing separates the mass into logs. The wood is automatically drawn into the shredder by the kinematics of the knives. The knives are made of high quality steel and can be separated. The BOBR 75 T is mountable behind small tractors with a three-point hitch category 1 N with a minimum power of 4 kW. The divider also includes a hitch for attaching a trailer behind small tractors. The BOBR 75 Transport wood chipper is equipped with a conveyor belt that transports the logs directly to the bucket.

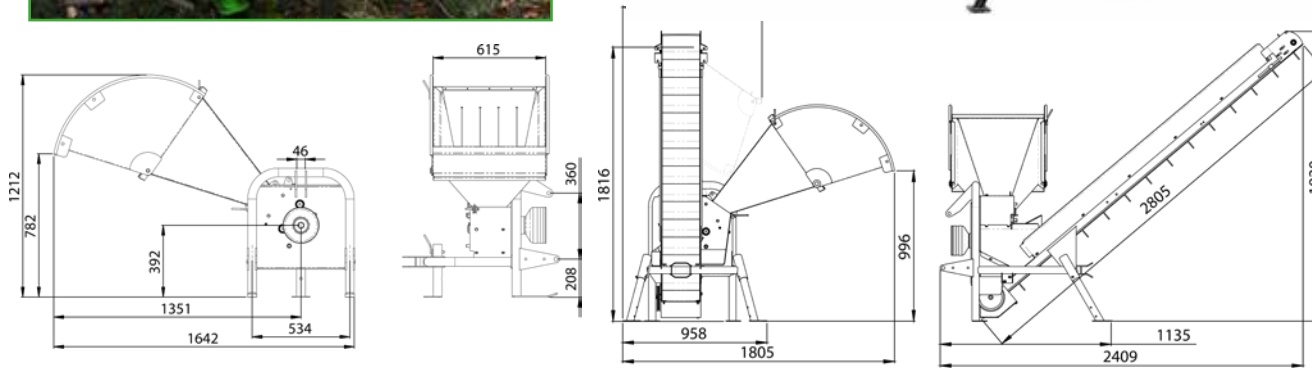

TECHNICAL DATA

number of blades	6	max. branch diameter	120 mm
blade drum speed	100 rpm	tractor power	25-50 HP
power output of the drive unit	min. 25 kWh	PTO speed	1 000 rpm
weight	230 kg	three-point hitch	category 1 and 1N
chip size	5-15 mm	funnel directional rotation	180°- 7 positions
power	5-10 m³/h	inserted profile (width x height)	622 x 622 mm

PZ-2

BAGGING DEVICE

The PZ-2 bagging device is designed for the wood waste splitter with BOBR 75 Transport and BOBR 120 Transport conveyor. This bagging device is mechanically attached by 2 screws to the conveyor of the divider with the possibility of height adjustment and easy assembly and disassembly. The bagging device is equipped with two hoppers with mechanical flap, which allows continuous operation when changing bags. This bagging device facilitates the subsequent handling of the blocks and especially the subsequent storage of the blocks.

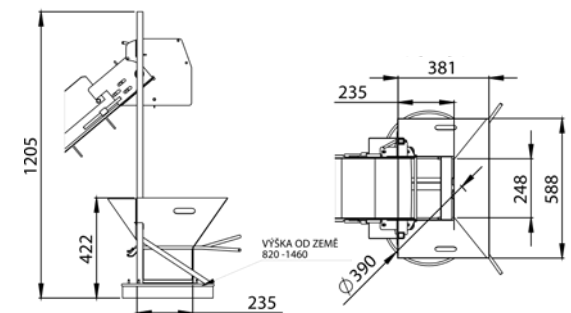

TECHNICAL DATA

weight	40 kg
--------------	-------



VINICULTURE

AGS-200 | AGP-250TN/200TN/100TN | AGP-1000PE | NOL-1400 | VNS-01 | AKR-60 T |

AGP-250TN/200TN/100TN

MOUNTED MIST BLOWERS

These are machines of modern construction designed to treat vines, orchards and other special crops by spraying with pesticide and non-pesticide products listed in the approved list of plant protection products. Thanks to their technical design, AGP mist blowers guarantee precise dosage and thus perfect spraying of plants in the form of mist. This ensures that the spraying agent is applied evenly to all parts of the plant. The adjustable fan blades deliver the most suitable amount of air to the plants to be treated. The spray tanks are made of high quality polyethylene. The sprayers are available in two versions - carried and pulled. The AGP 100 TN, 250 TN, 400 TN dew points with a 525 mm fan located in the middle of the polyethylene tank are also equipped with a clean water tank for dew point rinsing and hand washing.



TECHNICAL DATA AGP-100TN/AGP-250TN

polyethylene tank	100/250 l
pump	BM 80/30, PA 908 (Bertolini), KAPA 100
regulator	PR-1F3, PR 6F/3
nozzles	Albuz ATR
fan	ø 525 mm
output speed	12 000-22 000 m³ air/h
fan speed	12-34 m/s
connection	1 800 rpm
number of nozzles	l. category
pump drive	12
width	by PT shaft BKH-316
height	1 100/1 300 mm
length	580/1 470 mm
weight	1 450/970 mm
recommended capacity	114/155 kg
	22 kW

AGP-1000PE

TRAILED MIST BLOWER

Trailed mist blower AGROMEHANIKA 1000 PE with tank capacity 1000 l, with flushing, external fan 825fi/12-2. Trailed mist blower AGP 1000 PE is designed for protective spraying in vineyards and orchards.



TECHNICAL DATA

tank	1 100 l
pump	BERTOLINI PA 930 95 l/min/50 bar
regulator	BRAGLIA M 170
nozzles	Lechter TR
fan	diameter 825 mm
output speed	12 000 - 32 000 m³ air/h
chassis	12-32 m/s
number of nozzles	adjustable axle, single axle tyres 10.0/75-15.3
pump drive	8
purpose	with PTO shaft
weight	work in vineyards, orchards and hop gardens
dimensions	500 kg
	length 335 cm, width 105 cm, height 160 cm

AGS-200/6

MOUNTED FIELD SPRAYER

Area sprayers are intended for the area treatment of field crops with pesticide products specified in the list of authorised plant protection products in force, for area fertilisation with liquid fertilisers. The sprayer can also be used in vineyards and in winter for spraying brine solution. The sprayers are designed to be mounted on tractors with a category I standard hitch.



TECHNICAL DATA

tank capacity	200 l – polyethylene
spray bars	3 pcs (2x lateral + 1x central)
– working surface height	30 – 100 cm
– operating area width	6 m (on request 8 m)
– spray bars - side height	200 cm
	+ (20–100 cm working height)
noozles	12 pcs
– central bars	4 pcs
– side bars	4 pcs
– distance of nozzles on the bars	500 mm
pump	membrane BM 65/30,
	medium pressure with two membranes
Control valve	pressure regulator
	pressure gauge
valve for internal circulation circuit tank-pump-tank with no need to shut down tractor shaft	
5 valve distributor	1x valve middle arm
	1x valve left shoulder
	1x valve right shoulder
	1x valve for mixing back into the tank
	1x valve for hand spray gun

NOL-1400/NOL-1400 P

VINE TRIMMER

The front knife trimmers are designed for summer pruning in vineyards of any spacing. The machine works by means of rotating cutting blades to harvest overgrown vines. The residues of the cut material in the inter-row can be processed by shredding with a mulcher at the same time as the cutting. This combination leads to a considerable reduction in the time required for treating the vegetation. Easy operation of the working tools is ensured by a control located in the tractor driver's cab. The working height and inclination of the cutter bar can thus be adjusted directly via the hydraulic cylinders according to the condition of the crop and the supporting structure. The hydraulic motor drives a series of vertical and one or two horizontal rotors on which the blades are mounted. The trimmer can be used on all types of tractors equipped with a hydraulic generator ensuring sufficient oil supply at optimum working pressure. Thanks to the versatile design of the controls and the suspension on the tractor, the front hitch of the cutter can be used to attach other machines and thus increase the usefulness of the investment made.

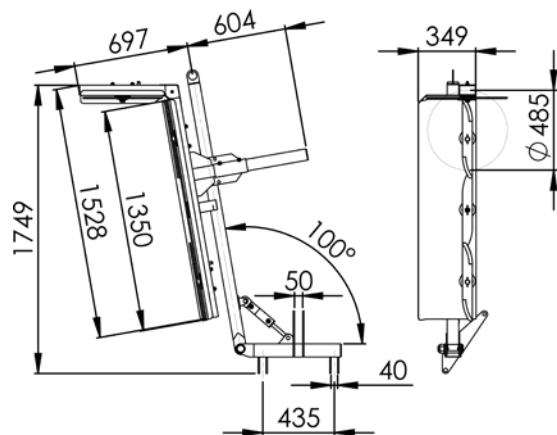

HEIGHT ADJUSTABLE VERSION NOL-1400 P

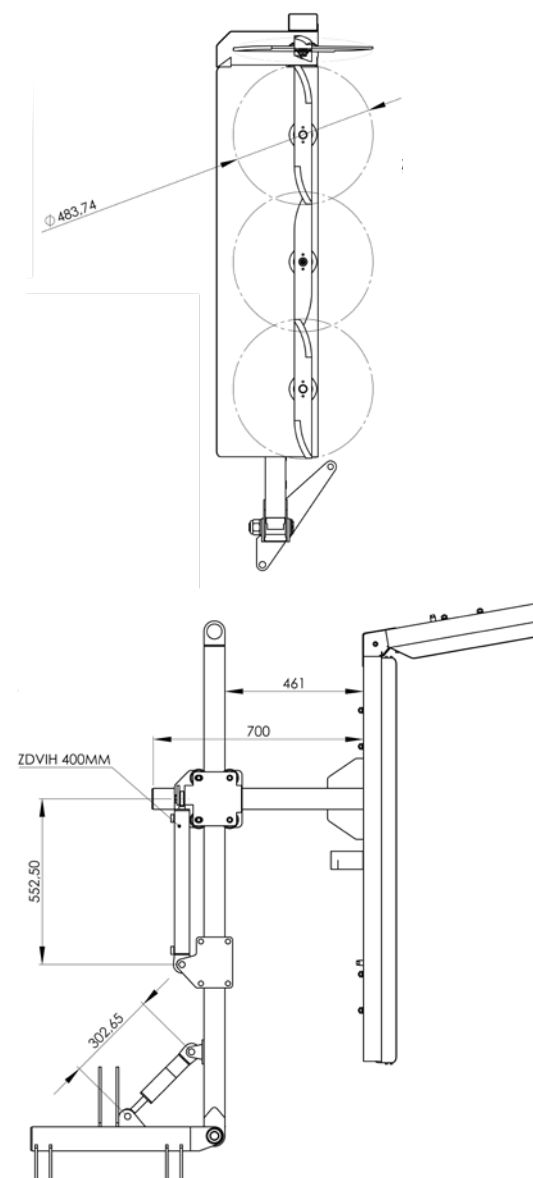

AKR-60 T

VINEYARD ROTAVATOR

The vineyard rotavator is a completely new additional device for working in the vineyard. The rotavator cultivates the area between the rows so that only the area around the individual vineyard heads is cultivated and the area for the movement of the small tractor remains grassed. The vineyard can then be entered by the small tractor even in poor weather conditions.

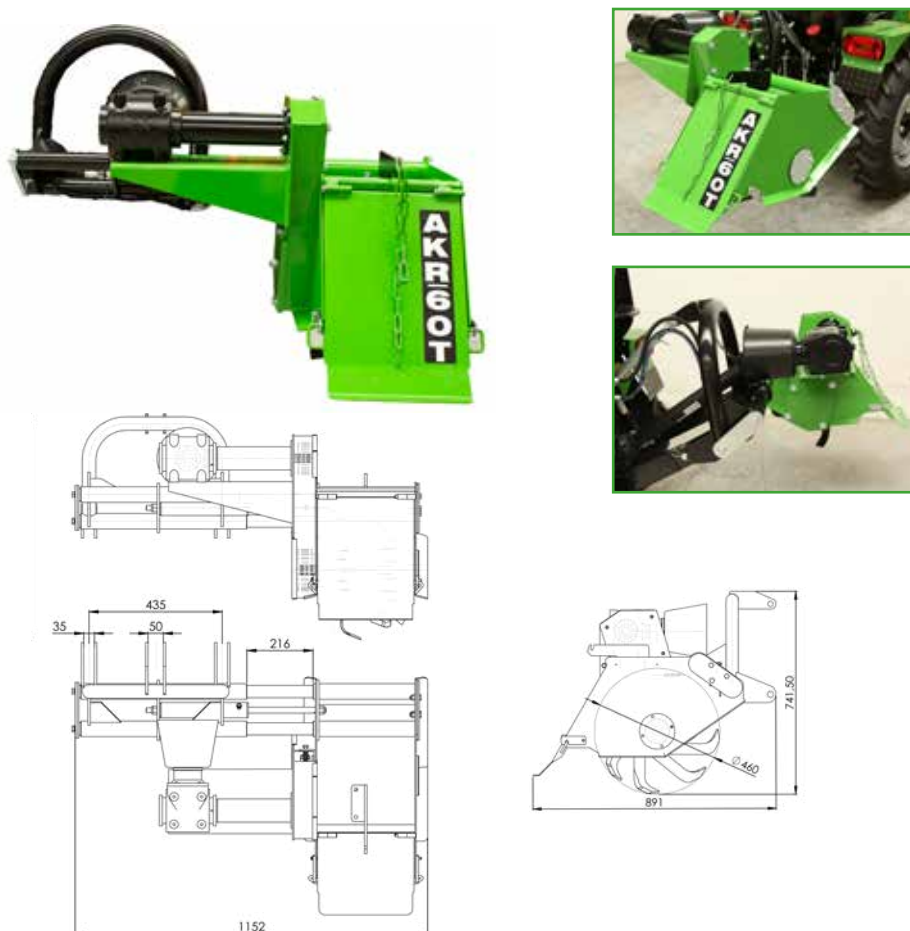

TECHNICAL DATA

horizontal pull-out	216 mm	working depth	150 mm
working width	320 mm	slope inclination	8°
height	741.5 mm	number of blades	4R+4L
width	1 152 mm	weight	123 kg
length	891 mm		

VNS-01

SWINGING KNIFE SECTION (WINE CULTIVATOR)

The swinging knife section is designed for easy and convenient soil cultivation and weed control between individual seedlings in vineyards and orchards. It is manufactured as a universal attachment allowing aggregation with all types of tractors equipped with a front three-point hitch of category 1 N. The precise and fast movement of the knife is controlled automatically by a specially connected hydraulic circuit and a sensitive gripper. A control located in the tractor driver's cab allows all important functions of the section to be operated manually at the same time at any time. The swivel knife sections are already equipped with a chisel or moldboard in the basic version, which serves for better penetration of the knife into the soil and at the same time protects the working knife shaft from damage.

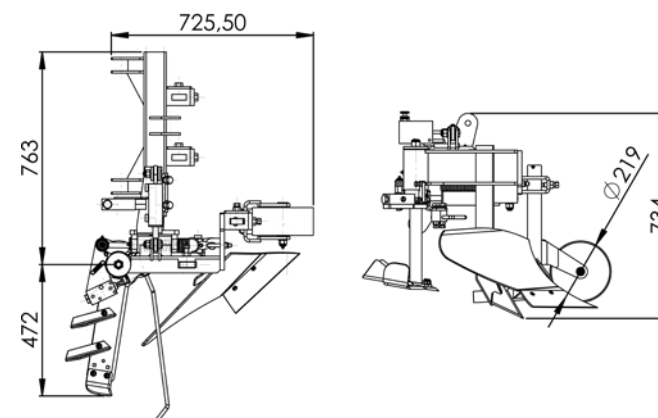

ACCESSORIES AND ADD-ONS

support wheel, knife coulters, straight disc coulters, disc coulters for ploughing/deodorising, ploughing coulters, ploughing coulters, special cultivation knife for ploughing, active finger cultivator and electric STOP button.



WINTER MAINTENANCE AND MUNICIPAL SERVICES

ARS-103 | RAZ-001 | ARS-171 | ARS-250 H/205H/188H/165H/140H/120H | SRS-205H/188H/165H/140H/120H |
SF-1500/1200 | AZM-156 | AZM-150HYDRO/120HYDRO | AZM-150M/120M | RZK-100 ROZMETADLO |
RZK-400 H/300H | VSN-140/120/100 | AZM-140 F |

ARS-103

FRONT HYDRAULIC PLOUGHSHARE WITH HYDRAULIC CYLINDER

The ploughshare is used for clearing snow from service areas, gardens and roads. It is also suitable for raking soil, sand to remove excrement from hard paddocks, etc. The plough can be mechanically swivelled in a horizontal position on both sides up to an angle of 45°. The ARS-103 ploughshare is aggregated by means of a frame which is part of the ploughshare. The frame is attached to the bottom of the front gearbox. The frame can be left mounted on the gearbox even when the coulter is not in use. The coulter is attached to the frame by two easily removable pins. The coulter is suitable for small tractors type TK-10, TZ-4K-14, MT8- 132.2, MT8-132.30 and MT8-232.30.

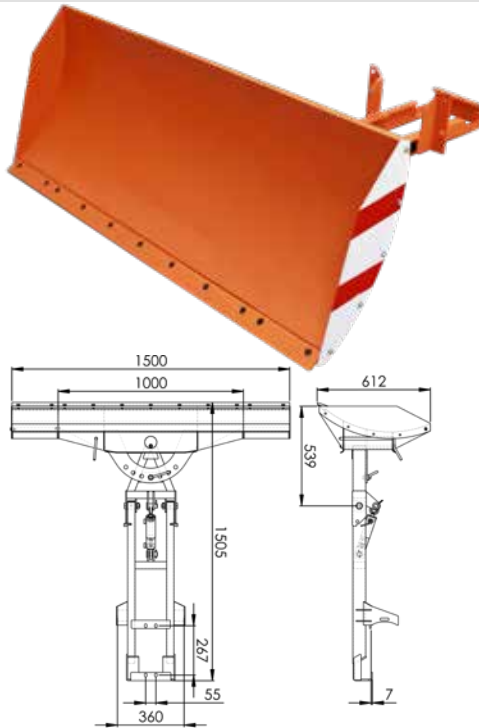

TECHNICAL DATA

length of the small tractor with plough.... 2 920 mm
max. working width..... 1 500 mm
min. working width..... 1 000 mm
max. working height 600 mm
weight 113 kg
max. steering angle..... 45°

RAZ-001

REAR PLOUGHSHARE

The ploughshare is used for snow ploughing from handling areas, gardens and roads, for raking soil and sand, for removing excrement from hard paddocks, etc. The plough can be rotated horizontally on both sides up to an angle of 45°. The advantages of the RAZ-001 ploughshare include use in space-restricted buildings, quick assembly and disassembly of the ploughshare to the small tractor, easy handling of the ploughshare in operation. The coulter can be connected to the small tractor by means of the DR2 103 quick hitch (not included in the coulter). The machine can be aggregated with all types of small tractors equipped with the ISO 730/1 N three-point hitch. A rubber snow blade can be added to the plough on request.

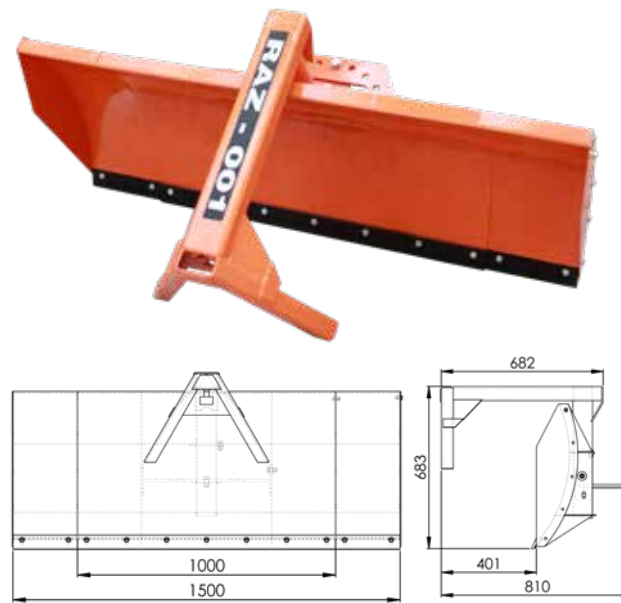

ADD-ONS

- hydraulic swivel of the coulter

TECHNICAL DATA

length..... 850 mm
working width of the ploughshare 1 500 mm
max working height 600 mm
max. steering angle 45°
total weight with accessories 72 kg

ARS-171

FRONT PLOUGHSHARE

The front ploughshare is used for clearing snow from service areas, gardens and roads. It is also suitable for raking soil, sand, removing excrement from hard paddocks, etc. The plough can be mechanically swivelled in a horizontal position on both sides up to an angle of 45°. The ARS-171 coulter is aggregated to the front three-point hitch of the small tractor by means of the DRZ-103 quick hitch. The coulter is suitable for all types of small tractors equipped with a front three-point hitch.

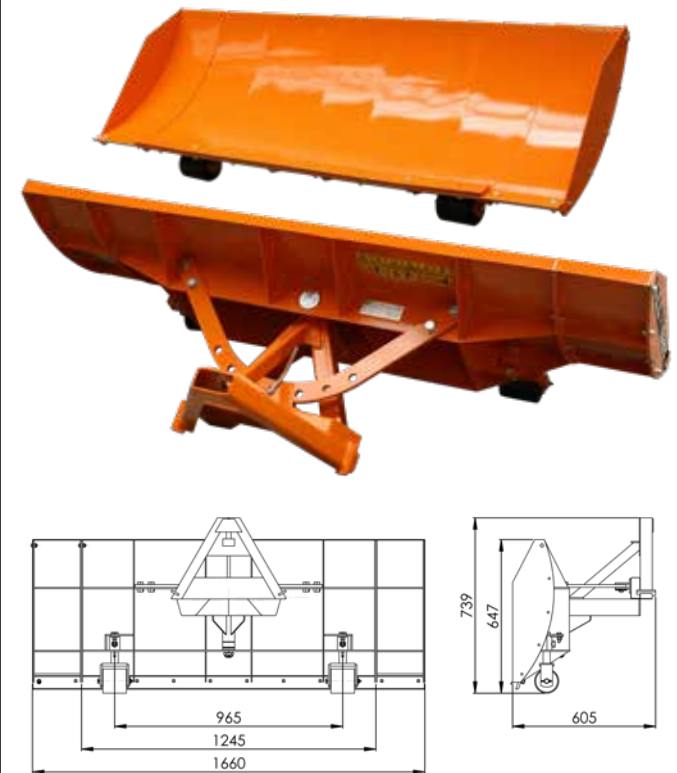

TECHNICAL DATA

length 620 mm
max. working width..... 1 750 mm
min. working width..... 1 250 mm
max. working height 600 mm
weight 106 kg
max. steering angle 45°

ARS

250H/205H/188H/165H/140H/120H

FRONT PLOUGHSHARE WITH HYDRAULIC CONTROL

The plough is designed for removing loose materials and snow from service areas and roads. The plough is hydraulically tilted by hydraulics directly from the driver's seat making it easier to handle. The plough is also equipped with a safety device against impact with a solid obstacle, in case of impact the plough is folded. The coulter is immediately returned to its original position by means of tension springs. The coulter is equipped with a rubber snow blade. The coulter can be applied using the front three-point hitch category ISO730/1 N. For easier application, the triangular quick hitch DRZ123 can be purchased with the small tractor. A shovel can be supplied on request in widths from 1200 mm to 2050 mm.

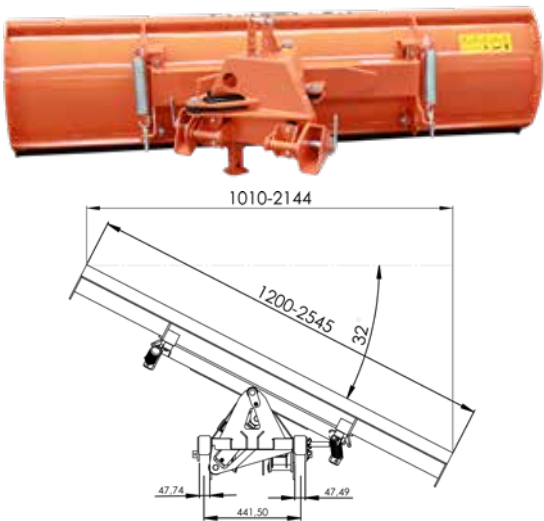

TECHNICAL DATA	120H	140H	165H
width	1 200 mm	1 400 mm	1 655 mm
height	473 mm	473 mm	473 mm
working width	1 010 mm	1 180 mm	1 395 mm
weight	80 kg	85 kg	90 kg
max. steering angle	34°	34°	34°
	188H	205H	
width	1 880 mm	2 550 mm	
height	473 mm	473 mm	
working width	1 730 mm	2 150 mm	
weight	102 kg	112 kg	
max. steering angle	34°	34°	

SRS

250H/205H/188H/165H/140H/120H

FRONT ARROW PLOUGHSHARE WITH HYDRAULIC CONTROL

The arrow plough is primarily designed for ploughing and shovelling loose materials and snow from handling areas and roads. This plough is hydraulically tilting, with hydraulic control directly from the driver's seat, which makes handling easier. Arrow movement is regulated by two linear hydraulic motors, controlled directly from the driver's seat, allowing the tilt and span of the plough to be adjusted. To increase snow removal efficiency, the plough blade is equipped with a rubber cutting edge. The ploughshare can be attached with a front three-point hitch of category ISO730/1 N. For easy mounting on a smaller tractor, an additional triangular quick hitch DRZ-123 can be purchased. If required, the plough can be ordered in different widths from 1200 mm to 2050 mm.

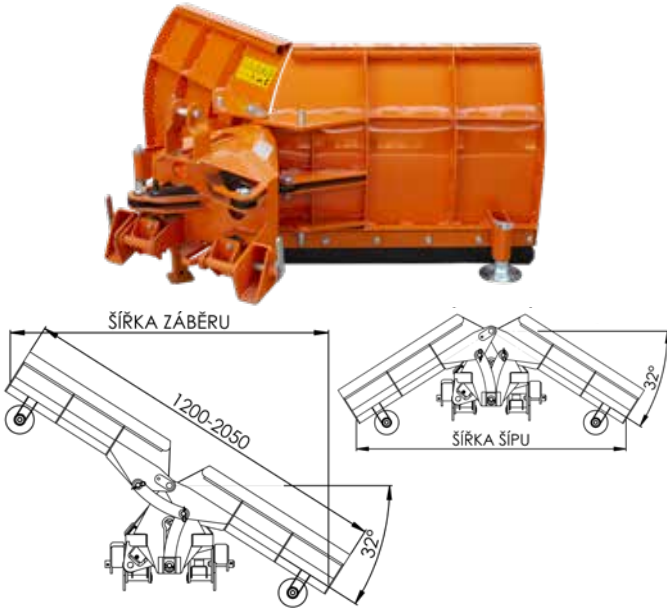

TECHNICAL DATA	120H	140H	165H
width	1 200 mm	1 400 mm	1 650 mm
height	500 mm	500 mm	500 mm
working width	1 010 mm	1 180 mm	1 395 mm
weight	105 kg	110 kg	115 kg
	188H	205H	
width	1 880 mm	2 050 mm	
height	500 mm	500 mm	
working width	1 585 mm	1 730 mm	
weight	125 kg	130 kg	

SF-1500/1200

SNOW CUTTER

The snow cutter is designed to remove a continuous layer of snow up to 300 mm on medium-sized flat and slightly inclined surfaces with a maximum slope of up to 12°. The cutter can be aggregated with tractors equipped with ISO730/1 N front three-point hitch including front PTO with minimum power over 19 kW. The cutter uses the tractor's front PTO for propulsion, the speed of which should be between 820 and 1 000 rpm. The cutter is driven by an articulated shaft.

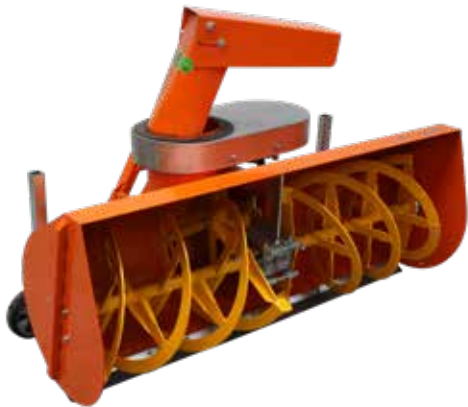

ADD-ONS

- hydraulic chimney winding
- hydraulic control of chimney tilting
- height adjustable support wheels

TECHNICAL DATA	SF-1200	SF-1500
total length	810 mm	810 mm
total width	1 250 mm	1 550 mm
total height	1 500 mm	1 500 mm
weight	150 kg	180 kg
working width	1 200 mm	1 500 mm
number of augers	2 pcs	
rotation of the sweeper	cca 1000 rpm	
height of snow layer	300 mm	
PTO shaft speed	820 up to 1 000 rpm	
max. operating speed	1.5 km/h	
max.working output	540 m³/h	
max.transport speed	15 km/h	
tractor axle gauge	max. 1 150 mm	
slope inclination	12°	

AZM-156

ROAD SWEEPER

The AZM-156 sweeper is used for sweeping municipal areas, pavements, roadways, sports fields and more. It can be used to sweep dust and dirt even on a smaller dusting of snow. The machine rotates against the direction of travel and collects dust in rows on the right side of the sweeping brush in the direction of travel of the small tractor. A sprinkler is placed in front of the brush, which can be used in case of increased dustiness. The brush is made of a mixture of steel and plastic bristles. The brush hinge is variable and can be rotated 180°. This allows the brush to be attached to both the front and rear three-point hitch of the small tractor. The brush is driven by a PTO shaft which connects the tractor drive shaft to the brush. The machine can be aggregated with all types of small tractors fitted with the ISO 730/1 N three-point hitch and can be connected in front or rear on request. For TK-12, TZ-4K-14 and MT8-132.2 small tractors, the machine must be aggregated using the FDZ-187 hitch



TECHNICAL DATA

total width	1 790 mm	weight	120 + 100 kg
length	1 650 mm	container volume	100 l
height	1 260 mm		
working width	1 200 mm		
max. working speed	4-5 km/h		

AZM-150hydro/120hydro

ROAD SWEEPER WITH HYDRAULIC MOTOR

The AZM-120Hydro and AZM-150Hydro sweeper brushes are used for sweeping municipal areas, pavements, roadways, sports fields, etc. They can be used for sweeping dust and dirt, or even for dusting snow during winter maintenance. The AMZ-120Hydro and AZM-150Hydro sweeping brushes are driven by their own hydraulic motor, which is connected via a control valve to determine the brush speed. For its application with a small tractor, the machine pump is connected to the hydraulic circuit of the small tractor by means of 2pcs quick couplers. For the proper functioning of the equipment, a pump with a flow rate of 20 l/min and a pressure of 8MPa is required on the small tractor. The machine can be easily aggregated for both front and rear applications using a 3 point hitch for small tractors with ISO730/1 and 1 N category hitches. Optionally, the brush swivel can be controlled hydraulically directly from the driver's seat using a straight-through hydraulic motor. The height-adjustable rubberised support wheels on the sides of the brush are used to press the brush onto the mat. The sweeping brushes can be equipped with a 200 litre pressure sprinkler. The pressure is provided by a 12 V electric pump. The 200 litre polyethylene container has its own frame so that the sprinkler can be applied independently with the small tractor in a three-point hitch. For rear application of the sweeper brush with sprinkling, the 200l container is placed directly on the brush so that it forms a compact unit.

ON REQUEST

- pressure spraying 200 litres
- dust collection container
- hydraulic brush rotation

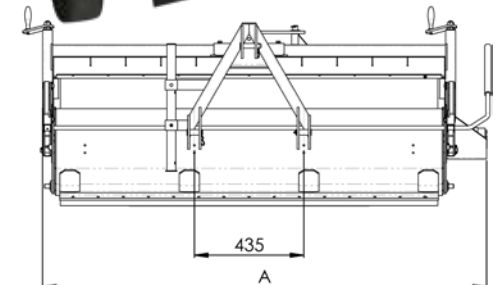
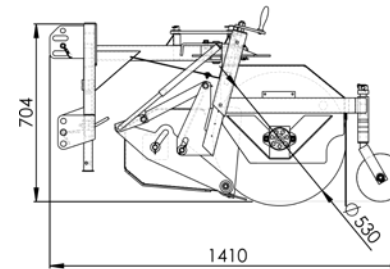

TECHNICAL DATA

	120 HYDRO	150 HYDRO
height	720 mm	720 mm
weight	130 kg	150 kg
working width	1 200 mm	1 500 mm
max. working speed	4-5 km/h	4-5 km/h
collecting container volume	108 l	135 l

AZM-150M/120M

ROAD SWEEPER WITH COLLECTION CONTAINER

The AZM-120M and AZM-150M sweepers are used for sweeping municipal areas, pavements, roadways, sports fields, etc. They can be used for sweeping dust and dirt, or even for dusting snow during winter maintenance. The AZM-120M and AZM-150M sweeping brush is driven mechanically by an angular gearbox using a PTO from the PTO shaft of the small tractor. The sweeping brush is equipped with a collection container for collecting dust and dirt. The tipping of the tub is mechanically operated as standard, but can optionally be operated hydraulically directly from the driver's seat using a straight-through hydraulic motor. Height-adjustable rubberised support wheels located on the sides of the brush are used to press the brush onto the mat. The machine is designed for rear application to the small tractor and can be easily aggregated using a rear three-point hitch of ISO730/1

and 1 N. The 200 litre polyethylene container has its own frame so that spraying can be applied separately with the small tractor to the three-point hitch. When the sweeper brush is applied with sprinkling, the 200l container is placed directly on the brush so that it forms a compact unit. The BK-300 side-sweeping disc is driven by a hydropropulsion system, which is connected via a control valve that determines the speed of the disc. For the application of the WK300 side-sweep disc, it is necessary to connect the machine pump to the hydraulic circuit of the small tractor by means of 2 quick couplers. For the correct operation of the machine, a pump with a flow rate of 20 l/min and a pressure of 8MPa is required on the small tractor. The machine can be easily aggregated using the rear three-point hitch for small tractors with ISO730/1 category hitch.

ON REQUEST

- pressure spraying 200 litres
- dust collection container
- hydraulic brush rotation

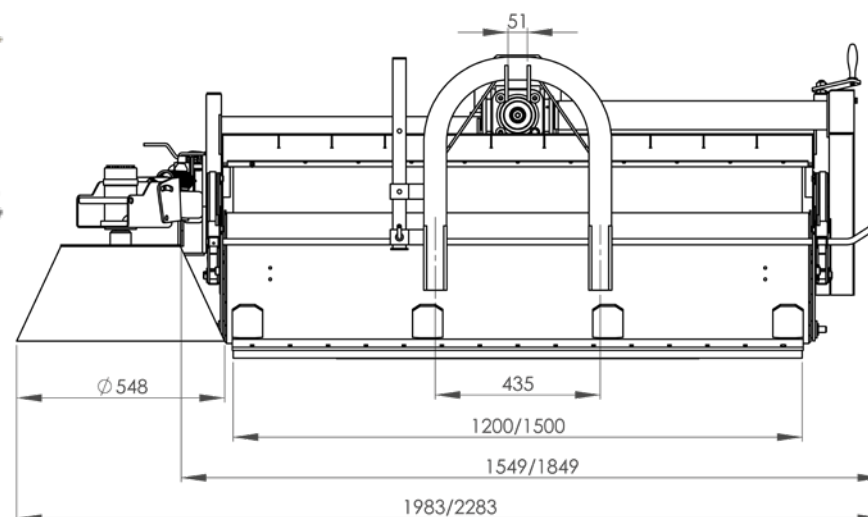
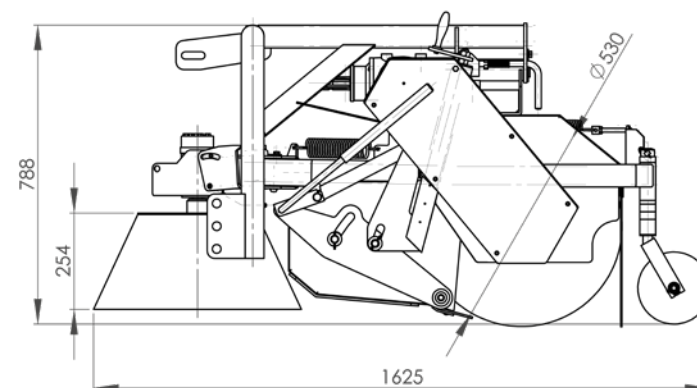

TECHNICAL DATA

	120 M	150 M
height	720 mm	720 mm
weight	130 kg	150 kg
working width	1 200 mm	1 500 mm
max. working speed.....	4-5 km/h	4-5 km/h
container volume	108 l	135 l

AZM-140 F

FRONT SWEEPER BRUSH

The sweeping brush AZM-140 F is used for sweeping municipal areas, sidewalks, roadways, sports fields and more. It can be used to sweep dust and dirt even on smaller dustings of snow. The machine rotates against the direction of travel and gathers dust in rows on the right or left side of the sweeping brush in the direction of travel of the small tractor. The brush is made of a mixture of steel and plastic bristles. The brush is driven by a PTO shaft which connects the shaft of the tractor drive mechanism to the brush. The machine can only be aggregated frontally with all types of small tractors fitted with ISO 730/1 N front three-point hitch.

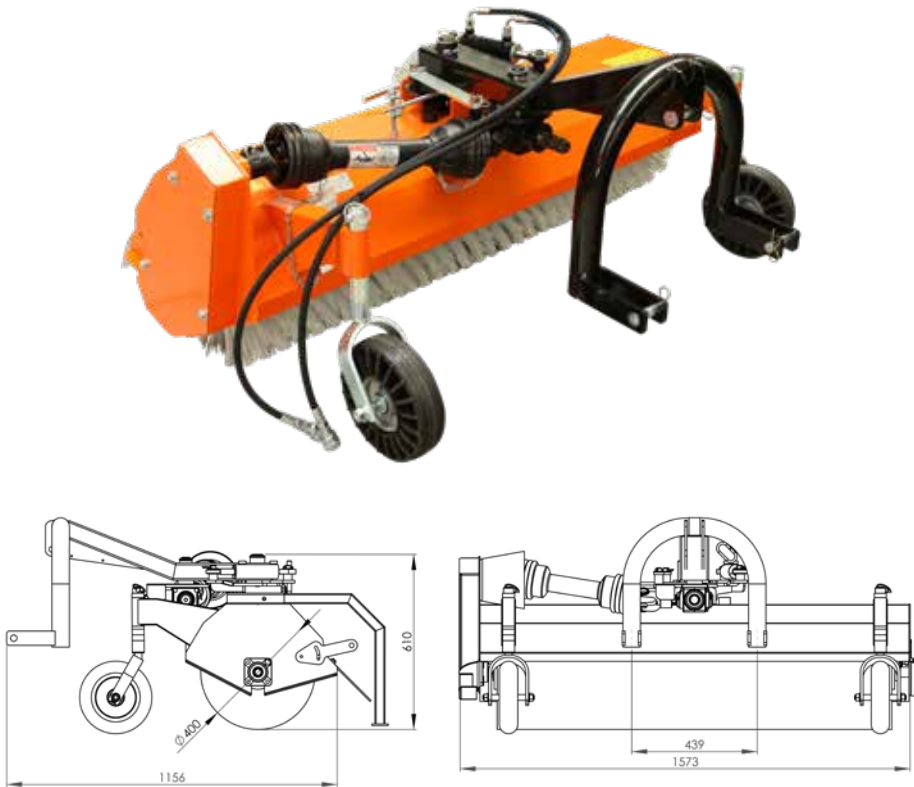

TECHNICAL DATA

working width	1 400 mm	sweeping brush diameter	400 mm
total width	1 573 mm	inclination angle	+/- 17°
height	610 mm		
length	1 156 mm		
max. working speed	4-5 km/h		

RZK-100

SPREADER

Spreaders are designed for spreading mineral, granular and powder fertilizers. In addition, spreaders are very well suited for spreading loose materials and salt on pavements and roads in winter. The spreader allows adjustment of the spreading angle, the quantity of spreading material and spreading to the left, right or both sides. The torque is transmitted by connecting the spreader drive shaft to the PTO shaft of the small tractor by means of an articulated shaft. The machine can be aggregated with all types of small tractors equipped with a three-point hitch ISO 730/1 N. For small tractors TK-12, TZ-4K-14 and MT8-132.2 it is necessary to aggregate the machine using the FDZ-187 hitch.



TECHNICAL DATA

length	850 mm	funnel capacity	151 l
width	850 mm	input shaft speed	540 rpm
height	880 mm		
weight	47 kg		
spreading width	1.5-1.7 m		

RZK-400 H/300H

BULK MATERIAL SPREADERS

Fertilizer spreaders are designed for spreading mineral granular fertilizers, but also for winter spreading of roads with loose materials and salts. In the basic version, the spreaders are equipped with a polyethylene hopper for 300 and 400 litres. The hopper is made of highly durable Canadian polyethylene. The spreader frame of tubular construction is protected with a high quality powder coat paint. The working mechanisms of the spreader are driven from the tractor's water shaft by a cardan shaft. The spreader's spreading and dosing gear is completely made of stainless steel. On the spreader plate there are 6 stainless steel blades, which are adjustable to 5 working positions, according to the spreading material used. The control plates are operated by control rods to regulate the dose and direction of spreading. For precise dosage adjustment, the control is equipped with a 0-9 scale, which is used to open the dosing holes in stages. The two-lever control mechanism allows either spreading over the entire working width or just to the right or left. The control mechanism is equipped with a hydraulic ON/OFF shut-off system. The machine can be aggregated with all types of small tractors equipped with a three-point hitch ISO 730/1 N. For small tractors TK-12, TZ-4K-14 and MT8-132.2 it is necessary to aggregate the machine using the FDZ-187 hitch. A winter spreading screen is standard equipment.



TECHNICAL DATA

	RZK-300	RZK-400
length	1 230 mm	1 150 mm
width	1 100 mm	1 170 mm
height	1 100 mm	1 170 mm
weight/use. weight.....	50 kg/350 kg	52 kg/400 kg
spreading width	6-14 m	6-14 m
hopper capacity	300 l	400 l
input shaft speed	540 rpm	540 rpm

VSN-140/120/100

CYLINDRICAL GRITTER

The VSN cylindrical gritter is a mounted work machine designed to be aggregated with a tractor or self-propelled work machine equipped with a category I or II rear three-point hitch, driven by the external hydraulic circuit of the carrier vehicle. It is intended for spreading inert material on roads.

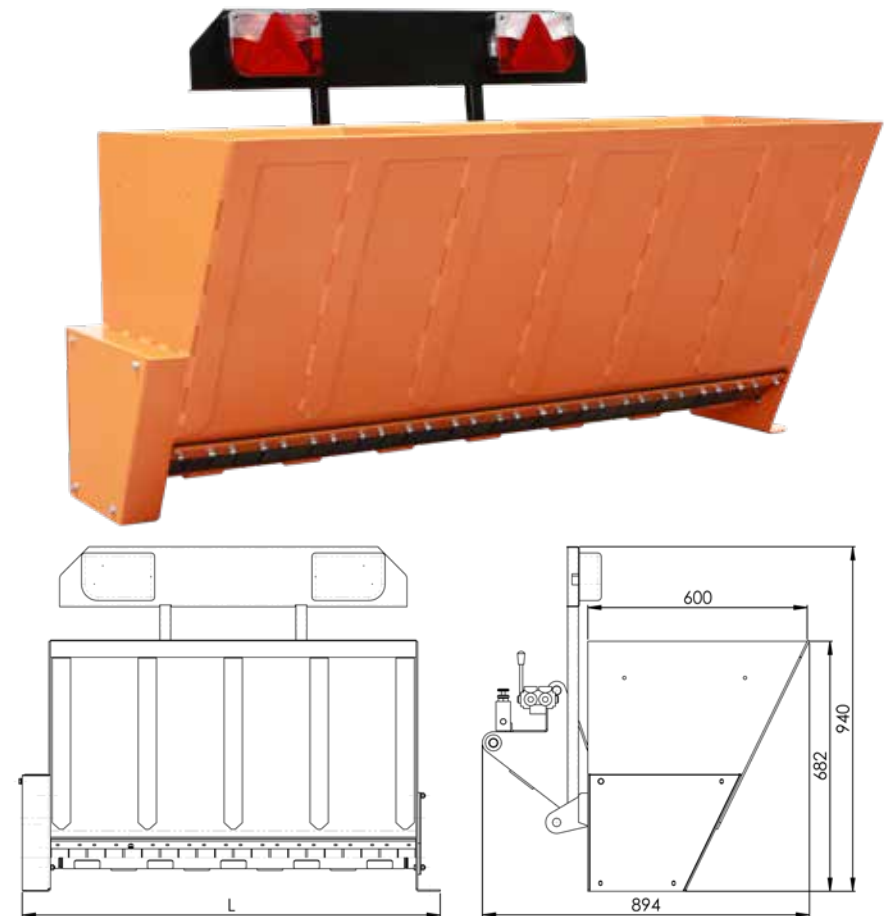

TECHNICAL DATA

	VSN-100	VSN-120	VSN-140
working width	1 000 mm	1 200 mm	1 400 mm
width	1 190 mm	1 390 mm	1 490 mm
container volume	0,205 m ³	0,245 m ³	0,310 m ³
weight	156 kg	185 kg	235 kg





FRONT LOADER

ND5-060 | ND6-060-A | ND5-060-B | ND5-060-C | ND5-060-D | ND5-060-E | ND5-060-F | ND5-060-G | ND5-060-H |

ND5-060

FRONT LOADER

The ND5-060 front loader is designed for VEGA, Cabrio, and MT8-050 series small tractors including their modifications. The loader drive is derived from the two external hydraulic circuits of the small tractor by means of quick couplers. The loader is mainly used for material handling, material loading, cleaning work, livestock farms, warehouses, horticulture, municipal services, construction and where there is not enough space for large tractors. The advantages of the ND5-060 front loader include easy and quick mounting of the equipment to the small tractor and easy and quick attachment and replacement of the working tool. The loader is easy to operate, even in smaller sites. A stabilising weight must be used when operating the loader.

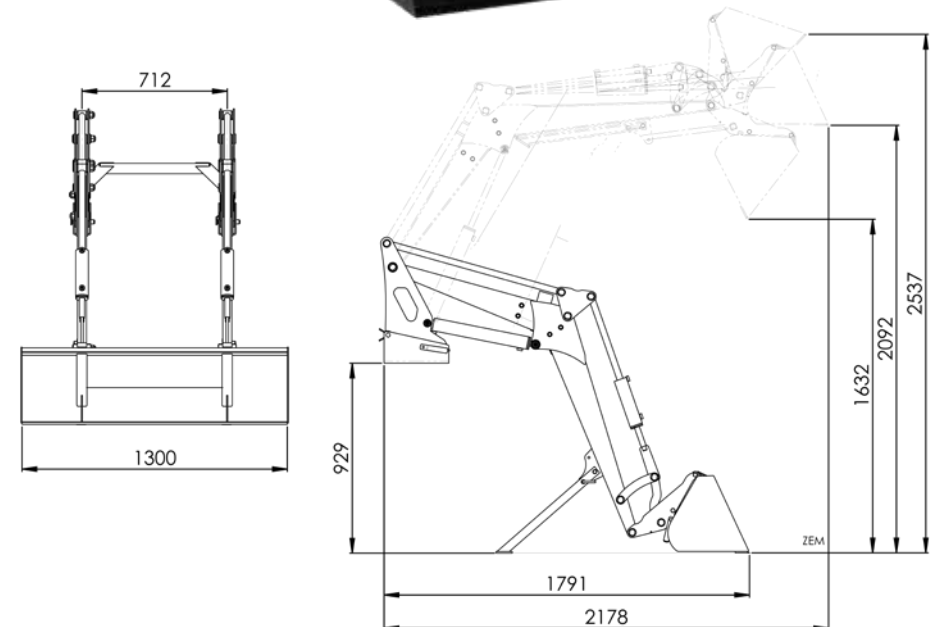

TECHNICAL DATA

max. loading height	2 060 mm	max. slope inclination	5°
max. dumping height.....	1 820 mm	max. width of the assembly	1 320 mm
below ground level reach	120 mm	loader operating pressure	805 MPa
hook capacity.....	250 kg	loader weight	140 kg
max. moving speed.....	6 km/h	weight of stabiliser weight	2x 50 kg

ND6-060-A

SHOVEL STANDARD

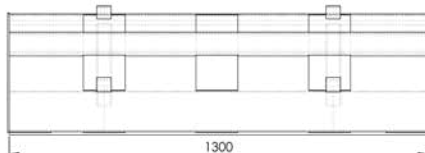

ND5-060-C

STACKING FORK

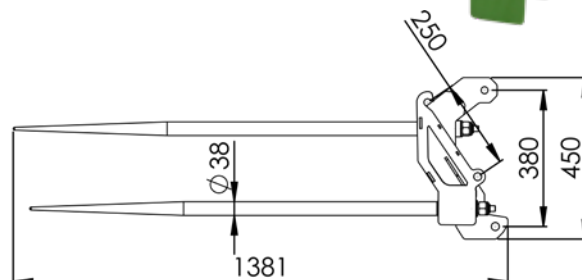
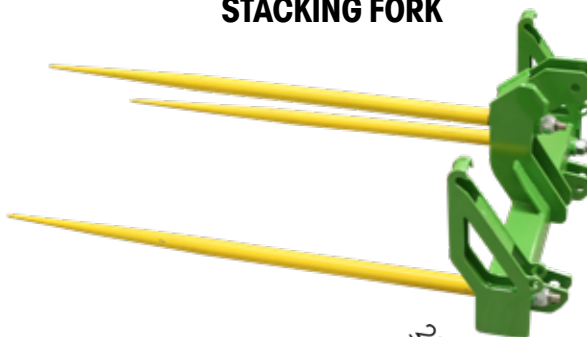

ND5-060-E

STACKING FORK WITH HOLDER

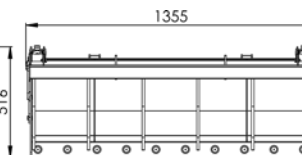
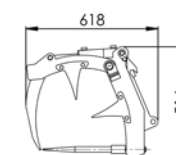
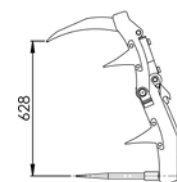

ND5-060-B

LARGE CAPACITY SHOVEL 300L

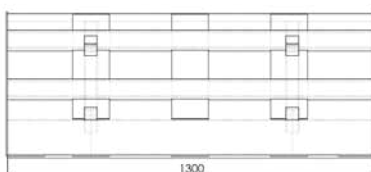
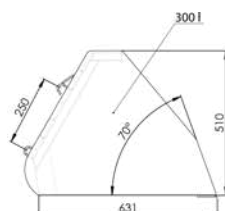

ND5-060-D

PALLETIZING FORK

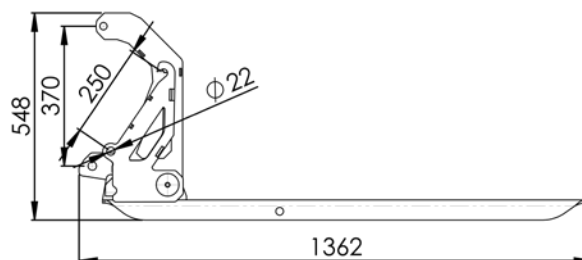

ND5-060-F

FORK TINES

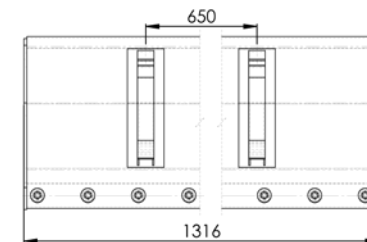
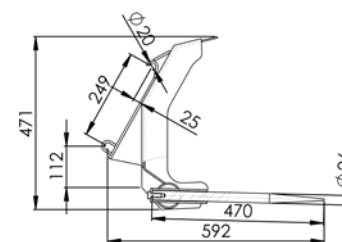

ND5-060-H

MULTIFUNCTIONAL SHOVEL

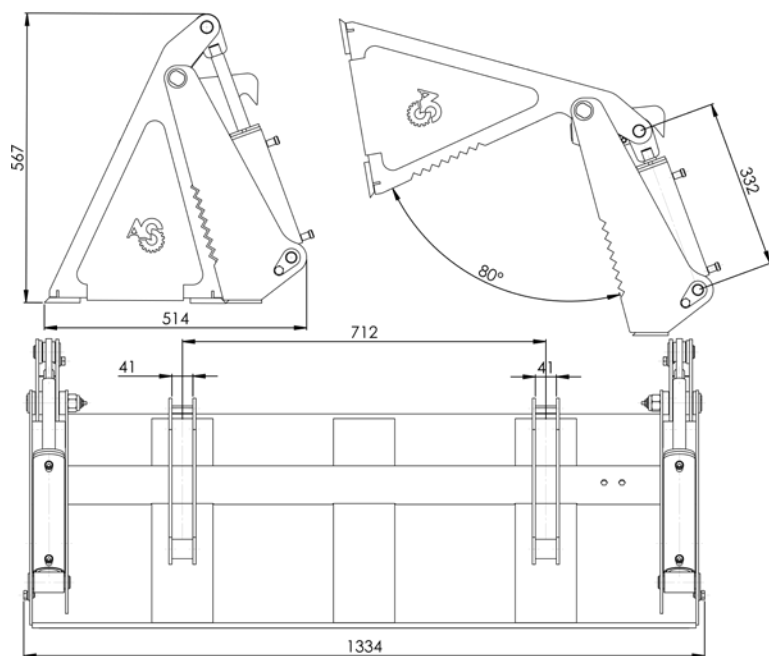

ND5-060-G

LOADING FORKS WITH SHOVEL

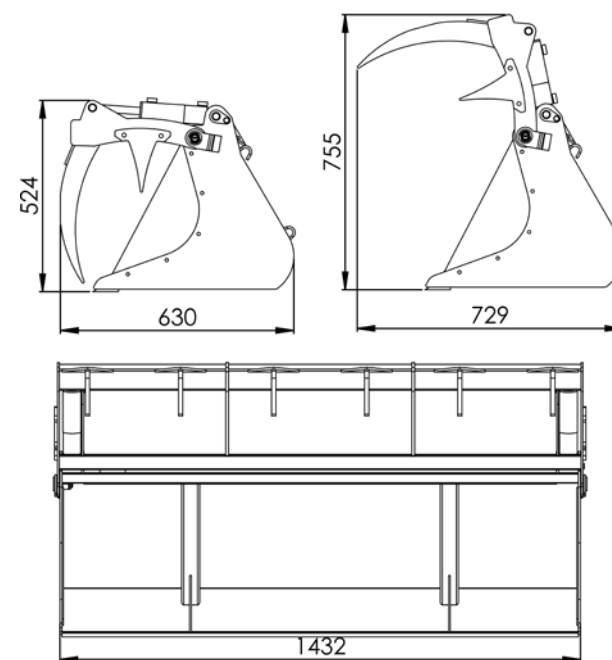



- Manufacture and sale of small tractors including accessories
- Spare parts
- Lombardini, Slavia, Kohler, Kubota and Htz engines
- General repairs
- CNC machining



Šálek s.r.o.

(area of the former Agrostroj Prostějov)
 Vrahovická 53, 796 01 Prostějov, Czech Republic
 tel.: +420 582 330 407
 mob: +420 730 530 407
 E-mail: salekp@salekp.cz
www.salekp.cz

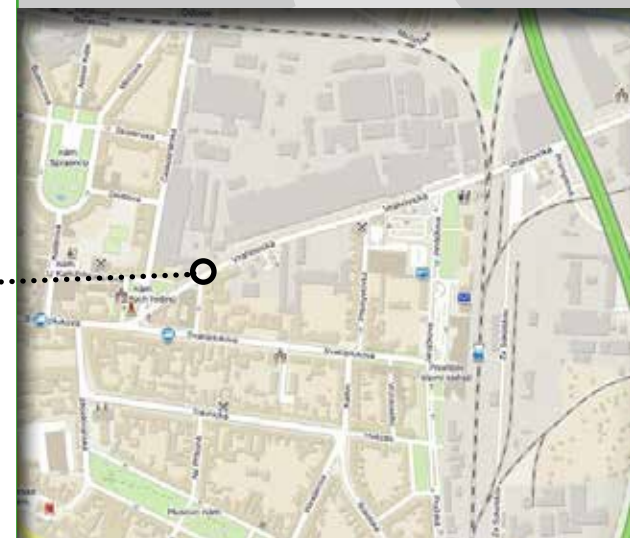
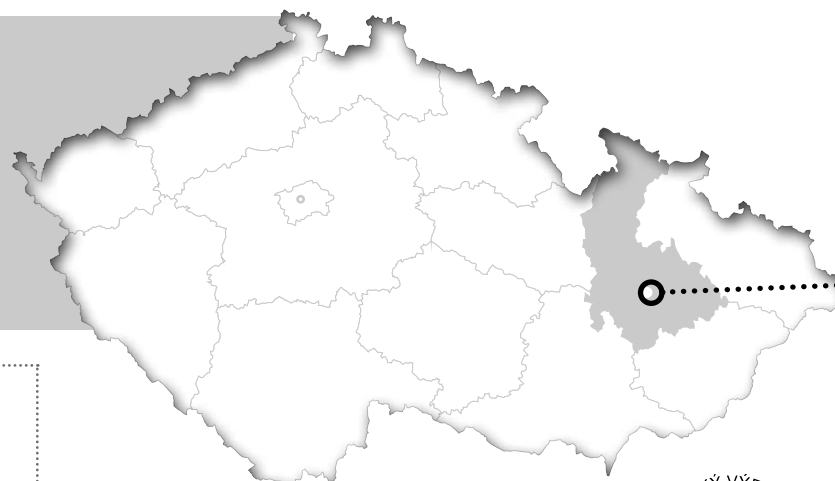

Your dealer



