

SERVICE PARTS LIST

GROUP:	5D
FORM:	8AL
FILE:	Alternator Parts List Section
DATE:	September, 1995

MODEL	VOLTS	AMPS
Various See Chart		

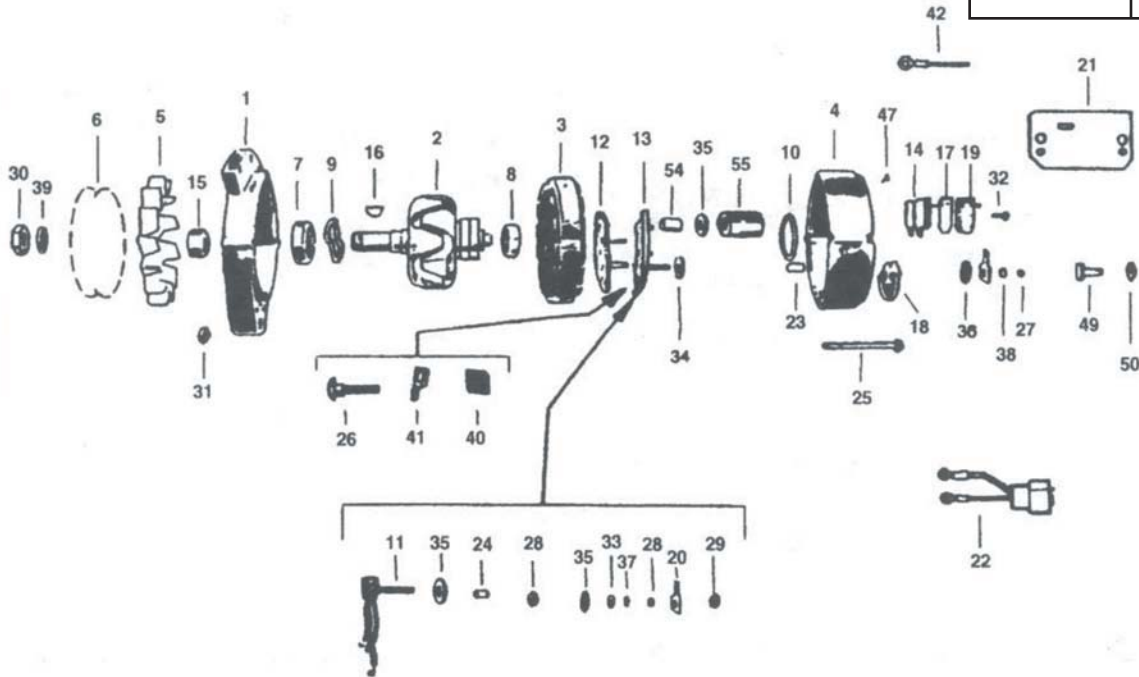

MODEL NO.	SALES NO.	1 HSNG FRONT	2 ROTOR ASSEM	3 STATOR ASSEM	4 HSNG REAR	5 FAN	6 PULLEY	7 BRNG FRONT	8 BRNG REAR	9 FR. BRNG RET	10 R. BRNG RET	11 DIODE FIELD	12 DIODE RCT NEG
8AL2046FA		114-93	112-88	113-74	114-98	107-8		111-21	111-23	111-3	111-25	101-130	101-236
8AL2055FA		114-55	112-88	113-74	114-98	107-8	107-85	111-21	111-23	111-3	111-25	101-130	101-236
8AL2074FA	110-500	114-270	112-92	113-77	114-98			111-21	111-23	111-3	111-25	101-228	101-243
8AL2080KA	110-497	114-55	112-89	113-75	114-98			111-21	111-23	111-3	111-25	101-130	101-286
8AL2098K	110-745	114-183	112-2	113-41	114-184	107-8	107-69	111-21	111-23	111-3	111-25		101-173
8AL2105L	110-770	114-1	112-29	113-9	114-104	107-8	107-5	111-21	111-23	111-3	111-25	101-130	101-152
8AL2106F	110-275	114-1	112-1	113-1	114-104	107-8		111-21	111-23	111-3	111-25	101-130	101-2
8AL2106FA	110-505	114-1	112-88	113-74	114-98	107-8		111-21	111-23	111-3	111-25	101-130	101-236
8AL2107K	110-300	114-1	112-2	113-19	114-98	107-8		111-21	111-23	111-3	111-25	101-130	101-126
8AL2107KA	110-503	114-1	112-89	113-75	114-98	107-8		111-21	111-23	111-3	111-25	101-130	101-236
8AL2108F	110-314	114-3	112-1	113-1	114-104	107-8		111-21	111-23	111-3	111-25	101-130	101-2
8AL2108FA	110-504	114-3	112-88	113-74	114-98	107-8		111-21	111-23	111-3	111-25	101-130	101-236
8AL2109F	110-317	114-1	112-1	113-1	114-104			111-21	111-23	111-3	111-25	101-130	101-2
8AL2109FA	110-492	114-1	112-88	113-74	114-98			111-21	111-23	111-3	111-25	101-130	101-236
8AL2110F		114-268	112-1	113-1	114-98		107-117	111-21	111-23	111-3	111-25		101-126
8AL2110FA		114-268	112-1	113-74	114-104		107-117	111-21	111-23	111-3	111-25		101-26
8AL2110FB		114-268	112-1	113-74	114-104		107-121	111-21	111-23	111-3	111-25		101-2
8AL2110FC		114-268	112-1	113-74	114-104		111-82	111-83	111-3	111-25			101-2
8AL2110FD		114-268	112-88	113-74	114-98		107-121	111-82	111-83	111-3	111-25		101-236
8AL2111F		114-268	112-1	113-74	114-104			111-82	111-83	111-3	111-25		101-2
8AL2111FA		114-268	112-88	113-74	114-98			111-82	111-83	111-3	111-25		101-236
8AL2116FA		114-268	112-1	113-74	114-104		107-122	111-21	111-23	111-3	111-25		101-126
8AL2116FB		114-268	112-88	113-74	114-98		107-122	111-21	111-23	111-3	111-25		101-236
8AL2171K	110-480	114-1	112-89	113-75	114-98			111-21	111-23	111-3	111-25	101-130	101-236

Important: The information contained in this bulletin is intended for use by trained, professional technicians who have the proper tools, equipment, and training to perform the required maintenance described above. This information is NOT intended for 'do-it-yourselfers', and you should not assume that this information applies to your equipment. If you have any questions regarding this information please visit our website at www.prestolite.com, or contact our technical service department at:

SERVICE PARTS LIST

GROUP:	5D
FORM:	8AL

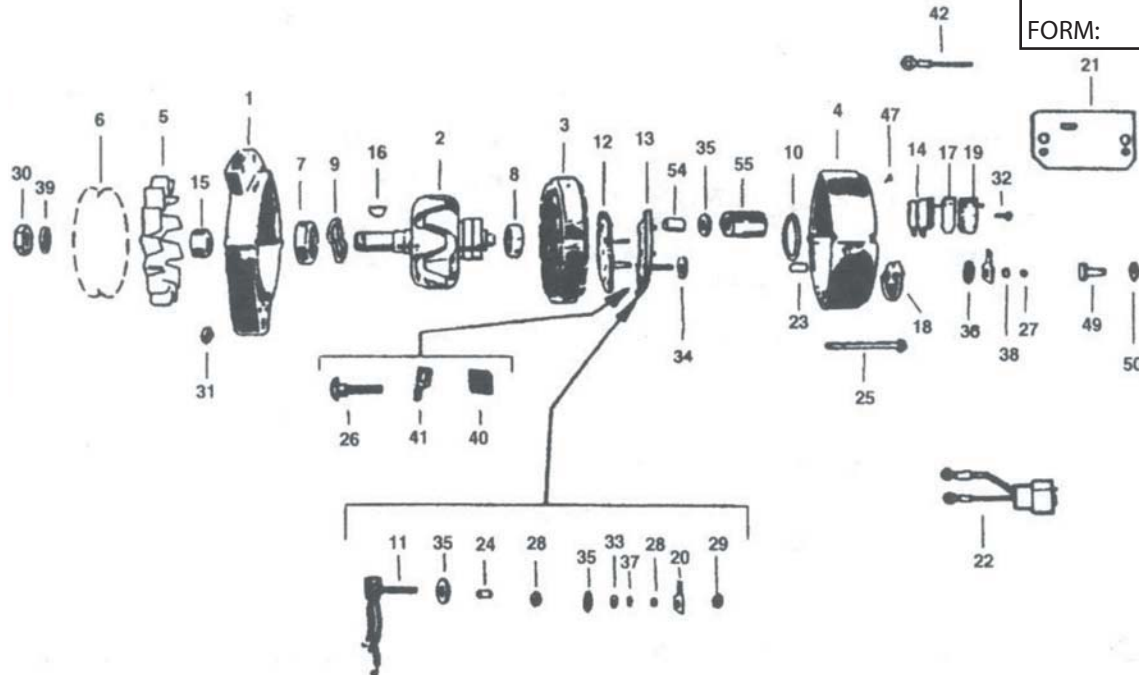

MODEL NO.	SALES NO.	13 DIODE RCT POS	14 BRUSH ASSEM	15 SPACER FAN&PUL	16 KEY WDRF	17 SHIELD DIRT	18 DIODE ISOL	19 TERM GROUND	20 TERM SPADE	22 CABLE ASSEM	23 SLEEVE INSUL	24 SLEEVE INSUL
8AL2046FA		101-241	103-15	120-375	120-7				103-6		115-26	115-27
8AL2055FA		101-241	103-15	120-375	120-7				103-6		115-26	115-27
8AL2074FA	110-500	101-242	103-15	120-385	120-241				103-6		115-26	115-27
8AL2080KA	110-497	101-241	103-15	120-375	120-7				103-6		115-26	115-27
8AL2098K	110-745	101-189	103-15	120-152	120-7	103-13			103-6	116-122	115-26	
8AL2105L	110-770	101-163	103-15	120-152	120-7	103-13		116-86	103-6		115-26	115-27
8AL2106F	110-275	101-171	103-15	120-152	120-7	103-13			103-6		115-26	115-27
8AL2106FA	110-505	101-241	103-15	120-375	120-7				103-6		115-26	115-27
8AL2107K	110-300	101-171	103-15	120-152	120-7	103-13			103-6		115-26	115-27
8AL2107KA	110-503	101-241	103-15	120-375	120-7				103-6		115-26	115-27
8AL2108F	110-314	101-171	103-15	120-152	120-7	103-13			103-6		115-26	115-27
8AL2108FA	110-504	101-241	103-15	120-375	120-7				103-6		115-26	115-27
8AL2109F	110-317	101-171	103-15	120-152	120-7	103-13			103-6		115-26	115-27
8AL2109FA	110-492	101-241	103-15		120-7				103-6		115-26	115-27
8AL2110F		101-1	103-15	120-349	120-7				103-6		115-26	115-27
8AL2110FA		101-171	103-15	120-349	120-7			116-141	103-6		115-26	115-27
8AL2110FB		101-171	103-15	120-349	120-7			116-141	103-6		115-26	115-27
8AL2110FC		101-171	103-15	120-349	120-7			116-141			115-26	115-27
8AL2110FD		101-241	103-15	120-349	120-7			116-141	103-6		115-26	115-27
8AL2111F		101-171	103-15	120-349	120-7			116-141	103-6		115-26	115-27
8AL2111FA		101-241	103-15	120-349	120-7			116-141	103-6		115-26	115-27
8AL2116FA		101-1	103-15	120-349	120-7			116-141	103-6		115-26	115-27
8AL2116FB		101-241	103-15	120-349	120-7				103-6		115-26	115-27
8AL2171K	110-480	101-241	103-15		120-7				103-6		115-26	115-27

Important: The information contained in this bulletin is intended for use by trained, professional technicians who have the proper tools, equipment, and training to perform the required maintenance described above. This information is NOT intended for 'do-it-yourselfers', and you should not assume that this information applies to your equipment. If you have any questions regarding this information please visit our website at www.prestolite.com, or contact our technical service department at:

GROUP:	5D
FORM:	8AL

KEY NO.	SALES NO.	DESCRIPTION	8AL2046FA	8AL2055FA	8AL2074FA	8AL2080KA	8AL2098K	8AL2105L	8AL2106F	8AL2106FA	8AL2107K	8AL2107KA	8AL2108F	8AL2108FA	8AL2109F	8AL2109FA	8AL2110F	8AL2110FA	8AL2110FB	8AL2110FC	8AL2110FD	8AL2111F	8AL2111FA	8AL2116FA	8AL2116FB	8AL2171K
		BOLTS																								
25	120-1	THROUGH, 10-32 x 2-55/64"	4	4	4				4	4			4	4	4	4	4	4	4	4	4	4	4	4	4	
25	120-143	THROUGH, 10-32 x 3-1/8"				4	4				4	4													4	
25	120-86	THROUGH, 10-32 x 3-5/16"						4																		
26	120-93	CARRIAGE, 10-24 x 1-1/2"	1	1	1				1	1	1		1		1		1	1	1	2	1	2	1	2	1	
26	120-306	CARRIAGE, M5 x .08 x 1.4			3	1																				
		NUTS																								
24	120-148	HEX LOCKNUT, 10-24 x 3/8"						3	3	3	3	3														
27	120-254	HEX, LOCKNUT M5 x .8			5																					
27	120-288	HEX, M5 x .08 - 6H					6																			
27	120-342	HEX, 1/4-20 x 7/16"	2	2	2			2	2	2	2	2	2	2	2	2	1	1	1	1	1	1	1	2	2	
27	120-376	HEX, 10-24	4	5	5				4	4	5	5	5	5	5	5	4	4	4	5	4	4	5	4	3	
28	120-34	HEX, 10-24 x 3/8"						3	3	3	3	3	3													
28	120-95	HEX, 10-24 x .38	2	2	2				2	2	2	2	2	1	1	1	1	1	2	1	2	1	2	2		
28	120-374	HEX, M5			2																					
28	120-384	CONICAL, M6 x 1.0			2																					
30	120-136	PULLEY MOUNTNG, 5/8-18 x 5/16"	1	1		1	1	1	1	1	1	1	1	1	1	1	1	1	1	1	1	1	1	1	1	
30	120-243	PULLEY MOUNTING, METRIC			1																					
31	120-150	SQUARE THROUGH BOLT MTNG, 10-32						4	4	4	4	4	4	4												
		INSULATOR																								
34	115-4	INSULATOR, 13/64" x 1/2" OD						2	2	2	2	2	2	2												
35	115-3	INSULATR, NO. 10 x 3/4" OD	2	2	2	2	4	1	1	2	1	2	1	2	1	4	2	2	2	2	2	2	2	2	2	
35	115-51	WASHER, INSL - NO. 10	4	4	4	4			4	4	4	4	4	4	8	1	1	1	4	1	4	8	4			
36	115-10	INSULATOR, 1/4" x 3/4" OD						2	2	2	2	2	2													
36	115-54	WASHER, INSL - 1/4"	2	2	2	2			2	2	2	2	2	2	2	2	2	2	2	2	2	2	2	2	2	
40	115-7	INSULATOR, SQUARE	1	1	1	1	1		1	1	1	1	1	1	1	1	1	1	1	2	1	2	1	2	1	
54	115-21	SLEEVE INSULATING, NO. 10					2		2																	
54	115-39	SLEEVE, INSULATING														1										
		SCREWS																								
32	120-102	TAPPING, 8-32 x 1/2"	2	2	2	2	2	2	2	2	2	2	2	2	2	2	2	2	2	2	2	2	1	2	2	
47	120-208	TAPPING, 4-40 x 3/16"						2	2	2	2	2	2	2												
47	120-234	TAPPING, 10-24 x 3/8"															1	1	1	1	1	1	1			
		WASHERS																								
33	120-109	FLAT METAL, .266 x .562	1	1	1				1	1	1	1	1	1											1	
33	120-120	FLAT METAL, NO. 10 x 9/16" OD	1	1	1	2	1	1	1	1	1	1	1	1	1	2	2	1	1	1		1	1	1	1	
37	120-111	SPLIT LOCK, NO. 10					6	3	3	3	3	3	3													
38	120-113	SPLIT LOCK, 1/4" STUD						2	2	2	2	2	2													
38	120-378	FLAT METAL - 203 ID	4	3	3				4	3	4	4	1	1	1	1	1	4	1	3	1	4	3			
39	120-137	SPLIT LOCK, 5/8"	1		1	1	1	1	1	1	1	1	1	1	1	1	1	1	1	1	1	1	1	1	1	
39	120-242	SPLIT LOCK			1																					
50	120-120	FLAT METAL, NO. 10 x 9/16" OD	1	1	1	1	1	1	1	1	1	1	1	1	1	1	1	1	1	1	1	1	1	1	1	
		MISC.																								
41	116-87	LUG TERMINAL					1			1																
41	120-380	A.C. LUG	1	1	1	1			1	1	1	1	1	1	1	1	1	2	1	2	1	2	1			
42	116-98	CABLE ASSEMBLY								1																
49	120-287	CAP STUD	2	2	1				1	1	1	1	1	1					1	1	1					
55	120-265	BUSHING, REAR SPLIT					1																			

Important: The information contained in this bulletin is intended for use by trained, professional technicians who have the proper tools, equipment, and training to perform the required maintenance described above. This information is NOT intended for 'do-it-yourselfers', and you should not assume that this information applies to your equipment. If you have any questions regarding this information please visit our website at www.prestolite.com, or contact our technical service department at: