

GROUP:	36
FORM:	8EM-8EN, 10/95
FILE:	Alternator Parts List Section
DATE:	October, 1995

MODEL	VOLTS	AMPS
Various See Chart		

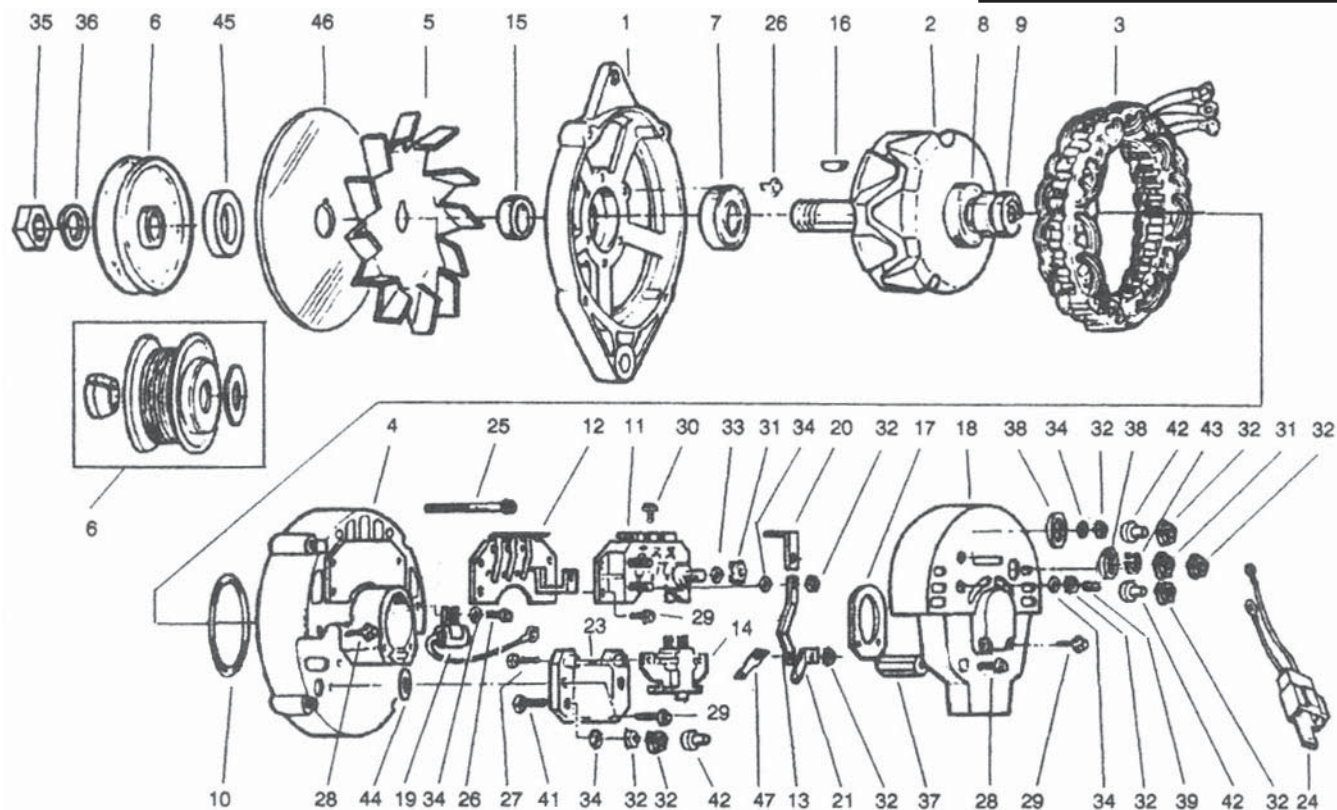

MODEL NO.	SALES NO.	1 HSNG FRONT	2 ROTOR ASSEM	3 STATOR ASSEM	4 HSNG REAR	5 FAN	6 PULLEY	7 BRNG FRONT	8 BRNG REAR	9 SLIP RING	10 R.BRNG RET.	11 FIELD DIODE	12 RECT. BRIDGE
8EM3001GA	110-371	114-227	112-69	113-58	114-222	107-82		111-21	111-21	112-22	111-64	101-208	101-207
8EM3002GA	110-376	114-227	112-70	113-58	114-222	107-68		111-21	111-21	112-22	111-64	101-208	101-207
8EM3002GB	110-376	114-227	112-70	113-58	114-222	107-68		111-21	111-21	112-22	111-64	101-208	101-207
8EM3002GC	110-376	114-227	112-70	113-58	114-222	107-68		111-21	111-21	112-22	111-64	101-208	101-207
8EM3003GA	110-384	114-223	112-70	113-58	114-222	107-68		111-21	111-21	112-22	111-64	101-206	101-207
8EM3004GA	110-394	114-227	112-70	113-58	114-222	107-68		111-21	111-21	112-22	111-64	101-208	101-207
8EN2001FA	110-341	114-223	112-65	113-54	114-222	107-68		111-21	111-21	112-22	111-64	101-206	101-207
8EN2002KA	110-359	114-223	112-64	113-53	114-222	107-68		111-21	111-21	112-22	111-64	101-206	101-207
8EN2003KA	110-360	114-225	112-64	113-53	114-222	107-68		111-21	111-21	112-22	111-64	101-206	101-207
8EN2004KA	110-361	114-223	112-64	113-53	114-222	107-68		111-21	111-21	112-22	111-64	101-206	101-207
8EN2005KA	110-366	114-235	112-64	113-53	114-222	107-68		111-21	111-21	112-22	111-64	101-206	101-207

Important: The information contained in this bulletin is intended for use by trained, professional technicians who have the proper tools, equipment, and training to perform the required maintenance described above. This information is NOT intended for 'do-it-yourselfers', and you should not assume that this information applies to your equipment. If you have any questions regarding this information please visit our website at www.prestolite.com, or contact our technical service department at:

GROUP:	36
FORM:	8EM-8EN, 10/95

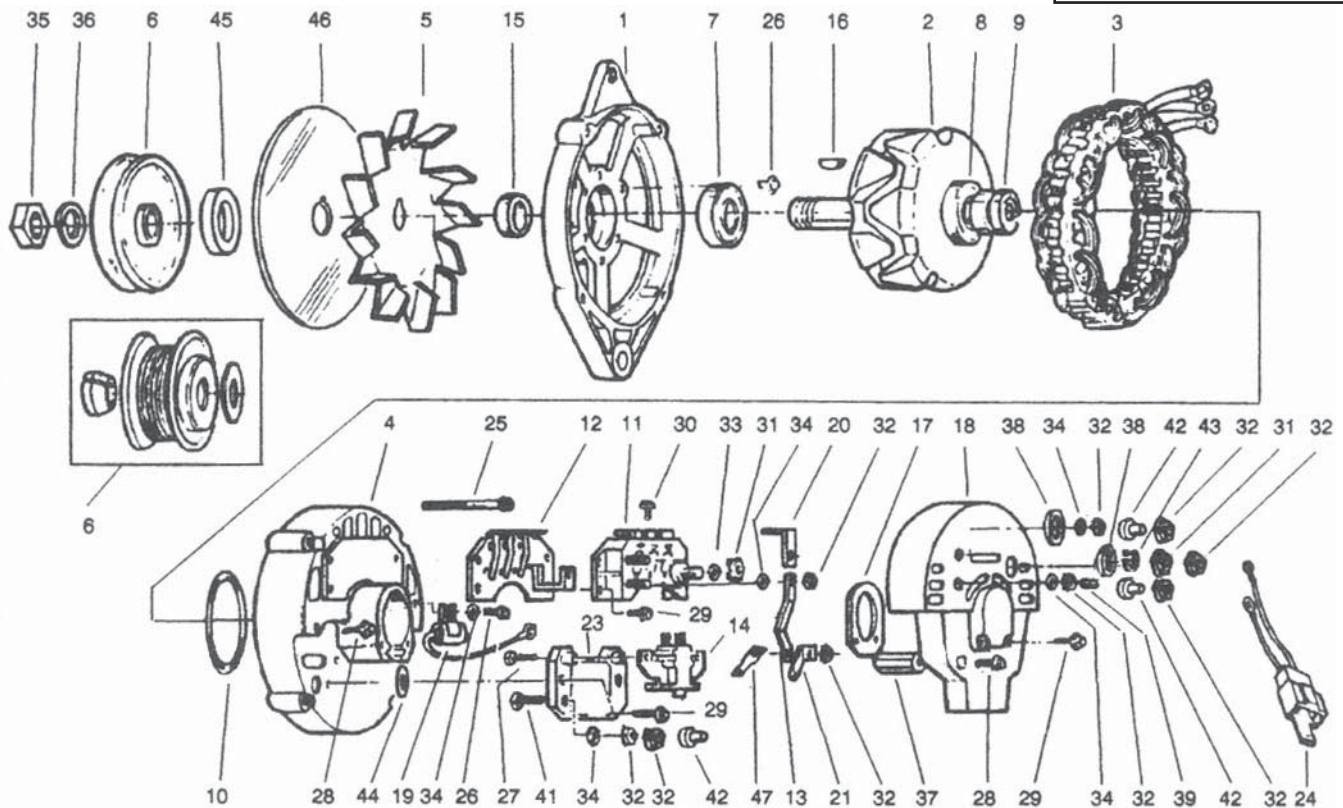

MODEL NO.	SALES NO.	13 D+ STRAP	14 BRUSH ASSEM	15 FAN SPACER	16 WDRFF KEY	17 FELT GASKET	18 COVER ASSEM	19 CAPA-CITOR	20 AC TAP LUG	21 TERM MALE	22 VOLT. REG.	23 BLANK HSNG	24 CABLE ASSEM
8EM3001GA	110-371	120-334	103-55	120-346		103-56	114-214	120-335			105-269		
8EM3002GA	110-376	120-334	103-55	120-152	120-7	103-56	114-214	120-335			105-270		
8EM3002GB	110-376	120-334	103-55	120-152	120-7	103-56	114-214	120-335			105-270		
8EM3002GC	110-376	120-334	103-55	120-152	120-7	103-56	114-214	120-335			105-270		
8EM3003GA	110-384	120-334	103-55	120-152	120-7	103-56	114-214	120-335			105-269		
8EM3004GA	110-394	120-334	103-55	120-152	120-7	103-56	114-214	120-335			105-270		
8EN2001FA	110-341		103-55	120-152	120-7	103-56	114-214	120-335		120-340		114-230	
8EN2002KA	110-359		103-55	120-152	120-7	103-56	114-214	120-335		120-340		114-230	
8EN2003KA	110-360		103-55	120-152	120-7	103-56	114-214	120-335		120-340		114-230	
8EN2004KA	110-361		103-55	120-152	120-7	103-56	114-214	120-335		120-340		114-230	
8EN2005KA	110-366		103-55	120-152	120-7	103-56	114-214	120-335		120-340		114-230	

Important: The information contained in this bulletin is intended for use by trained, professional technicians who have the proper tools, equipment, and training to perform the required maintenance described above. This information is NOT intended for 'do-it-yourselfers', and you should not assume that this information applies to your equipment. If you have any questions regarding this information please visit our website at www.prestolite.com, or contact our technical service department at:

GROUP:	36
FORM:	8EM-8EN, 10/95

[illegible]

Important: The information contained in this bulletin is intended for use by trained, professional technicians who have the proper tools, equipment, and training to perform the required maintenance described above. This information is NOT intended for 'do-it-yourselfers,' and you should not assume that this information applies to your equipment. If you have any questions regarding this information please visit our website at www.prestolite.com , or contact our technical service department at: